

**APPLICATION CHECKLIST**

Portage County, Nelson Twp.  
 Soinski SWN #5, Perm.#  
 SWIW # 41

	Date	Initials
Enter on Agenda	6/7/12	AA
Completeness Review	7-3-12	AA
Date - Time Stamp	6-7-12	AA
Area of Review	6/17/12	AA
Site Evaluation	8-9-12	AA
Permitting Section		
Memo to Inspector	7-26-12	Jmlr
Public Notice	08-01-12	Jmlr
Letter	08-01-12	
Date Run		
15 Days		
Review Public Notice		
Affidavit of Notification		
Objections Received	Yes _____ No _____	
Public Hearing Date		
Chief's Order, if Required		
Schematic	6/18/12	AA
Plot on Map	6/28/12	AA
Review by Geologist		
Permit Conditions (Same date as permit)		
Enter on Computer (Same or later date than Chief's Order)		
Enter on Master List	6/7/12	AA
EPA Form	7/2/2012	Jmlr
Mail Permit		
Update Agenda		
File		

**RECORD OF CONVERSATION**

- Depth changes made to I & 203 to reflect casing program on back of 203
- Need ~~surface facility~~ sketch & SWIW aff. Davit
- Received surface sketch

# DAILY ROUTE SLIP *Nelson*

APPLICATION NO. aPATT020711 TYPE: Salt Water Injection Well

CONAME HARD ROCK DRILLING & PR API

WELL NAME /NO. SOINSKI 5

COUNTY 133 PORTAGE INITIALS DATE

DATE APPLICATION REC'D *PN* 6/7/2012

PERMIT FEE AND CHECK NO. \$1,000.00 1160

RUSH AMOUNT RUSH CHECK NO. \$0.00 0

APPLICATION ENTERED *PN* 6/7/12

APPLICATIONS AND PLATS SENT FOR MINE APPROVAL \_\_\_\_\_

COAL APPROVAL RECEIVED \_\_\_\_\_

OIL/GAS AFFIDAVIT REC'D \_\_\_\_\_

URBANIZED AREA NOTIFICATION SENT \_\_\_\_\_

URBANIZED AREA NOTIFICATION SENT TO INSPECTOR/REC'D BACK \_\_\_\_\_

URBAN MAP REVIEW \_\_\_\_\_

SAMPLES: YES \_\_\_\_\_ /SPECIAL AREAS \_\_\_\_\_

GEOLOGIST APPROVAL \_\_\_\_\_

DATA ENTRY /ISSUED \_\_\_\_\_

PERMIT: TAKEN \_\_\_\_\_ MAILED \_\_\_\_\_

FAX TO: \_\_\_\_\_

FINAL MAP CHECK \_\_\_\_\_

COMMENTS: \_\_\_\_\_

\_\_\_\_\_

\_\_\_\_\_

\_\_\_\_\_

\_\_\_\_\_

# Proof Sheet

<b>APPL NUMBER</b>	aPATT020711	<b>URBANIZED AREA ?</b>	<input type="checkbox"/>
<b>OWNER NUMBER</b>	8837	<b>NAME</b>	
<b>OWNER NAME</b>	HARD ROCK DRILLING & PROD LLC		
<b>EXISTING WELL</b>	0		
<b>API PERMIT NO</b>		<b>DISPOSAL PLAN 1</b>	ND
<b>APPL TYPE</b>	SWIW	<b>DISPOSAL PLAN 2</b>	
<b>TYPE OF WELL</b>	SWD	<b>DISPOSAL PLAN 3</b>	
<b>VARIANCE REQUEST</b>		<b>DISPOSAL PLAN 4</b>	
<b>WELL NAME</b>	SOINSKI SWD #5	<b>DISPOSAL PLAN 5</b>	
<b>WELL NUMBER</b>	5	<b>MP Check #</b>	0
<b>PREV/PROPOSED TD</b>	4200		
<b>DRILL UNIT ACRES</b>	446.27		
<b>TYPE OF TOOL</b>	RTAF	<b>PROPOSED FORMATIONS</b>	
<b>WELL CLASS</b>	SWIW	NEWBURG	
<b>FIRE PHONE</b>	( ) - 911		
<b>MEDICAL PHONE</b>	( ) - 911		
<b>COUNTY CODE</b>	133		
<b>COUNTY NAME</b>	PORTAGE		
<b>COAL (Y=-1/N=0)</b>	0	<b>TARG CIVIL TWP</b>	
<b>CIVIL TOWNSHIP</b>	NELSON	<b>TARG QUAD</b>	
<b>SURF QUAD</b>	GARRETTSVILLE	<b>Nad 27 TARG ORIG X</b>	
<b>Nad 27 SURF ORIG X</b>	2,408,449	<b>Nad 27 TARG ORIG Y</b>	
<b>Nad 27 SURF ORIG Y</b>	589,249	<b>TARG ELEV</b>	0
<b>GROUND ELEVATION</b>	945	<b>TARG SECTION</b>	
<b>SURF SEC</b>		<b>TARG LOT</b>	
<b>SURF LOT</b>	45	<b>TARG QTR TWP</b>	
<b>SURF QTR TWP</b>		<b>TARG ALLOT</b>	
<b>SURF ALLOT</b>		<b>TARG TRACT</b>	
<b>SURF TRACT</b>		<b>TARG FRACTION</b>	
<b>SURF FRACTION</b>			

SWIW  
41

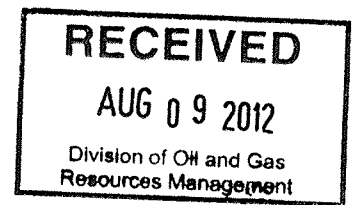

Ohio Department of Natural Resources  
Division of Mineral Resources Management  
2045 Morse Rd. Bldg. H-3 – Columbus OH 43229-6693



*SWIW Permit Conditions*

<b>Application Number</b>	<b>SWIW #41</b>	<b>Permit Number</b>	<b>Inspection Date</b>	08/02/12	<b>Modification Date (if applicable)</b>
<b>Company</b>	Hard Rock Drilling and Producing, LLC		<b>Lease Name/Well #</b>	Soinski #5	
<b>County</b>	Portage		<b>Township</b>	Nelson	
<b>Section/Lot</b>	Lot 45		<b>Urban Area</b>	N/A	
<b>Inspected By</b>	Stephen Ochs				
<b>Accompanied By</b>	C.J. Cutter (Company) and Dale Soinski (Landowner)				
<b>Directions to Location</b>	US 422; 4.5 miles south on SR 534; 3 miles west on SR 82; access on the north side of road				

ITEM	LEASE ROAD, WELL SITE CONSTRUCTION	Comments:
1	Tree/Brush Removal/Disposition	N/A
2	Topsoil Removal/Stockpiles/Placement	N/A
3	Erosion/Sediment Control (Silt Fence, Berms)	Silt fence used where needed
4	Drainage Controls (Diversion Ditches, Culverts, Waterways, Crossings)	Existing drainage controls
5	Signage	As required by OAC 1501: 9-3-06
6	Apron/Culverts/Road Material	Existing access road
7	Pull Off Area	Well site
8	Parking	Well site
9	GPS – Access Road	41.25569 -81.02827
10	GPS – Well Stake	41.27460 -81.01378
11	GPS – Tank Battery	41.26170 -81.01926

ITEM	DRILLING CONSIDERATIONS	Comments:		
12	Noise Mitigation (Mufflers, Extra Frac Tanks, Tarps)	N/A		
13	Rig Type	Fluid and Air Rotary		
14	Is a Blow-out Preventor required?	X	Yes	No
	If No, explain:			
15	Equipment Placement/ Orientation (Rig/ Frac Tanks/ etc.)	N/A		
16	Drilling Pits (Placement/Orientation)	N/A		
17	Fencing (Pits/Entire Location)	N/A		
18	Flood Plain	Approx. 0.3 miles from Eagle Creek		
19	Mine Voids	None		
20	Verify Water Wells Within 300'	None		
21	Verify Structures Within 500'	None		
22	Verify Streams and Drainage	Drainage east toward Eagle Creek		

ITEM	RESTORATION	Comments:		
23	Pit Closure – (Standard/ Solidification/ Off-Site Disposal – state time frame)	Once total depth has been reached, the drilling equipment will be removed and pits will be closed within two months.		
24	Site Specific Time Frame For Restoration	All restoration will be completed within six months after drilling is commenced.		
25	Erosion/Sediment Control	Maintain until preliminary restoration is completed		
26	Drainage Control	Maintain until final restoration is completed		

ITEM	PRODUCTION	Comments:		
27	Is the Access Road Gate required?	X	Yes	No
	If No, explain:			
28	Landscaping/Screening (Wellhead, Tank Battery) (Waiver Attached if applicable)	N/A		
29	Fencing (Wellhead, Tank Battery) (Waiver Attached if applicable)	N/A		

WAIVERS	Comments:		
Is the Company required to submit a waiver?	Yes	X	No
If yes, submit the following waiver requests:			

Is the Company required to submit revised drawings?  Yes  X  No

THE FOLLOWING ITEMS HAVE BEEN CHANGED FROM THE ORIGINAL APPLICATION:



# Ohio Department of Natural Resources

JOHN R. KASICH, GOVERNOR

JAMES ZEHRINGER, DIRECTOR

## Division of Oil and Gas Resources Management

*Richard J. Simmers, Chief*

2045 Morse Road, Bldg. F-2

Columbus, OH 43229-6693

Phone: (614) 265-6633 Fax: (614) 265-7998

August 1, 2012

**Mr. Charles J. Cutter**

Hard Rock Drilling and Production, LLC

7646 Cedar Valley Road

West Salem, Ohio 44287

**RE: Public Notification for SWIW application for Portage County, Nelson Twp. and Windham Twp., seven new wells, Hard Rock Drilling and Production, LLC, Soinski #1, #21, #31, #41, #5, #6, and #7 injection wells.**

Dear **Mr. Cutter**:

As outlined in Rule 1501: 9-3-06 (H) (1) of the Ohio Administrative Code, please consider this letter as notification from the Division for you to proceed with the public notice. Enclosed, please find a copy of the notice you will need to have run in the newspaper of general circulation in the area of the proposed injection well. **The public notice must be run for no less than five consecutive days. After running this notice in the newspaper, please send me the original proof-of-publication from the newspaper as soon as possible.**

If you have any questions regarding this matter, please feel free to contact me at (614) 265-1032.

Sincerely,

  
**Tom Tomastik**, Geologist

UIC Section

Division of Oil and Gas Resources Management

2045 Morse Road, F-2

Columbus, Ohio 43229-6693

Cc: File

## PUBLIC NOTICE

Hardrock Drilling and Production, LLC, 7646 Cedar Valley Road, West Salem, Ohio (419) 846-3850 is applying to permit seven wells for the injection of brine water produced in association with oil and natural gas. The location of the proposed injection wells are: Soinski SWD #1 and #4I wells at Lot 89; Soinski SWD #2I and #3I wells at Lot 90 in Windham Township; Soinski SWD #5, #6 and #7 at Lot 45 in Nelson Township; Portage County, Ohio. The proposed wells will inject into Newburg dolomite at a depth of 4000 to 4200 feet. The average injection is estimated to be 800 barrels per day. The maximum injection pressure is estimated to be 920 psi. Further information can be obtained by contacting Hardrock Drilling and Production, LLC or the Division of Oil and Gas Resources Management. The address of the Division is: Ohio Department of Natural Resources, Division of Oil and Gas Resources Management, 2045 Morse Road, Building F-2, Columbus, Ohio 43229-6693, (614) 265-6633. For full consideration, all comments and objections must be received by the Division, in writing, within fifteen calendar days of the last date of this published legal notice.

**INTER-OFFICE MEMO**

**TO: Stephen Ochs, Mineral Resources Inspector**  
**FROM: Glenda M. Besana-Ostman, Geologist** *gmb*  
**SUBJECT: Application and Site Evaluation for a SWIW permit**  
**DATE: July 26, 2012**

The Division of Oil and Gas Resources Management has received an application for the proposed saltwater injection well as described below:

**OPERATOR: HARD ROCK DRILLING & PRODUCING LLC**  
**WELL NAME & NUMBER: SOINSKI # 5**  
**PERMIT NUMBER: NEW WELL, SWIW # 41**  
**LOCATION: 925' SL & 2342' WL of LOT 45, NELSON Twp., PORTAGE County**  
**PROPOSED INJECTION ZONE: NEWBURG DOLOMITE**  
**DATE RECEIVED: JUNE 7, 2012**

Please inspect proposed site and evaluate for any potential water wells or surface bodies of water within close proximity that would require any additional permit conditions for the construction of the SWIW surface facilities. Please e-mail me a copy of the site inspection report with any recommendations.



I certify that all known drilling or producing wells within 2640 feet and that all buildings and streams within 200 feet have been shown, that there are no drilling unit lines nearer than 1/4 section and that this plat is true and correct and was prepared according to the current State of Ohio, Department of Natural Resources, Division of Oil and Gas Regulations.

*Edward A. Gasbarre* s/es/12  
 Edward A. Gasbarre PS 7036

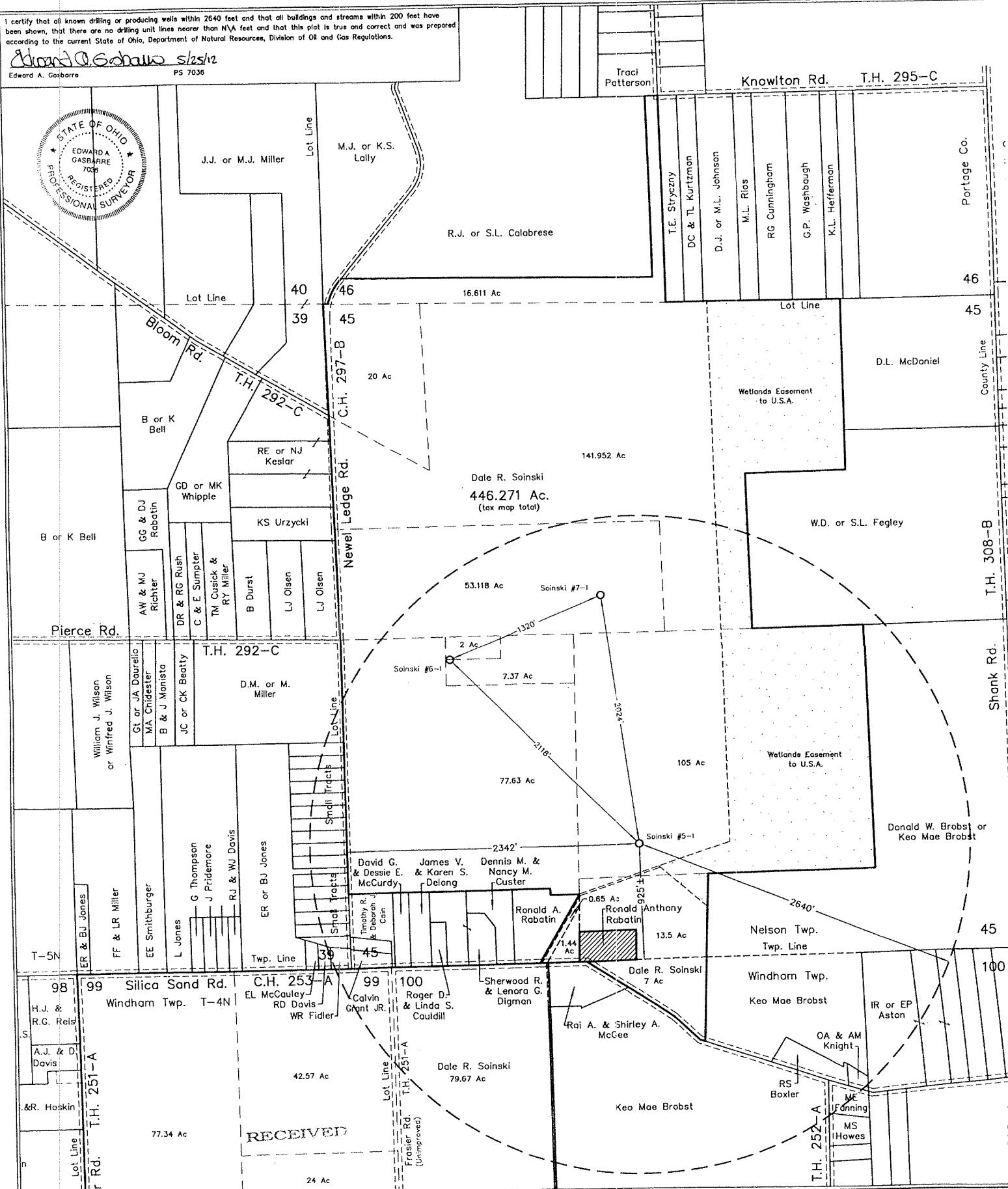

**Soinski Injection Well #5-I**  
 Nelson Township  
 Lot 45, T-5N, R-6W (Connecticut Western Reserve)  
 Portage County, Ohio

Plane Coordinates: Ohio North Zone, Garrettsville Quadrangle  
 NAD83 (US Survey Feet) NAD27 (US Survey Feet)  
 N 589,280 E 2,376,988 H 945 (NAVD88) (derived from GPS observations)  
 Urbanized Area N/A  
 Scale 1" = 500'

Prepared For: Hardrock Drilling and Producing  
 9270 Cedar Valley Road  
 West Salem, Ohio 44287  
 Date: May 25, 2011  
 Drawing: Master\_21  
**R.W. GASBARRE & Associates, Inc.**  
 Professional Land Surveyors  
 401 South Market St. - P.O. Box  
 Wooster, Ohio 44691  
 PH 330-264-9499

Portage County, Nelson Twp.

Soinski SWD #5



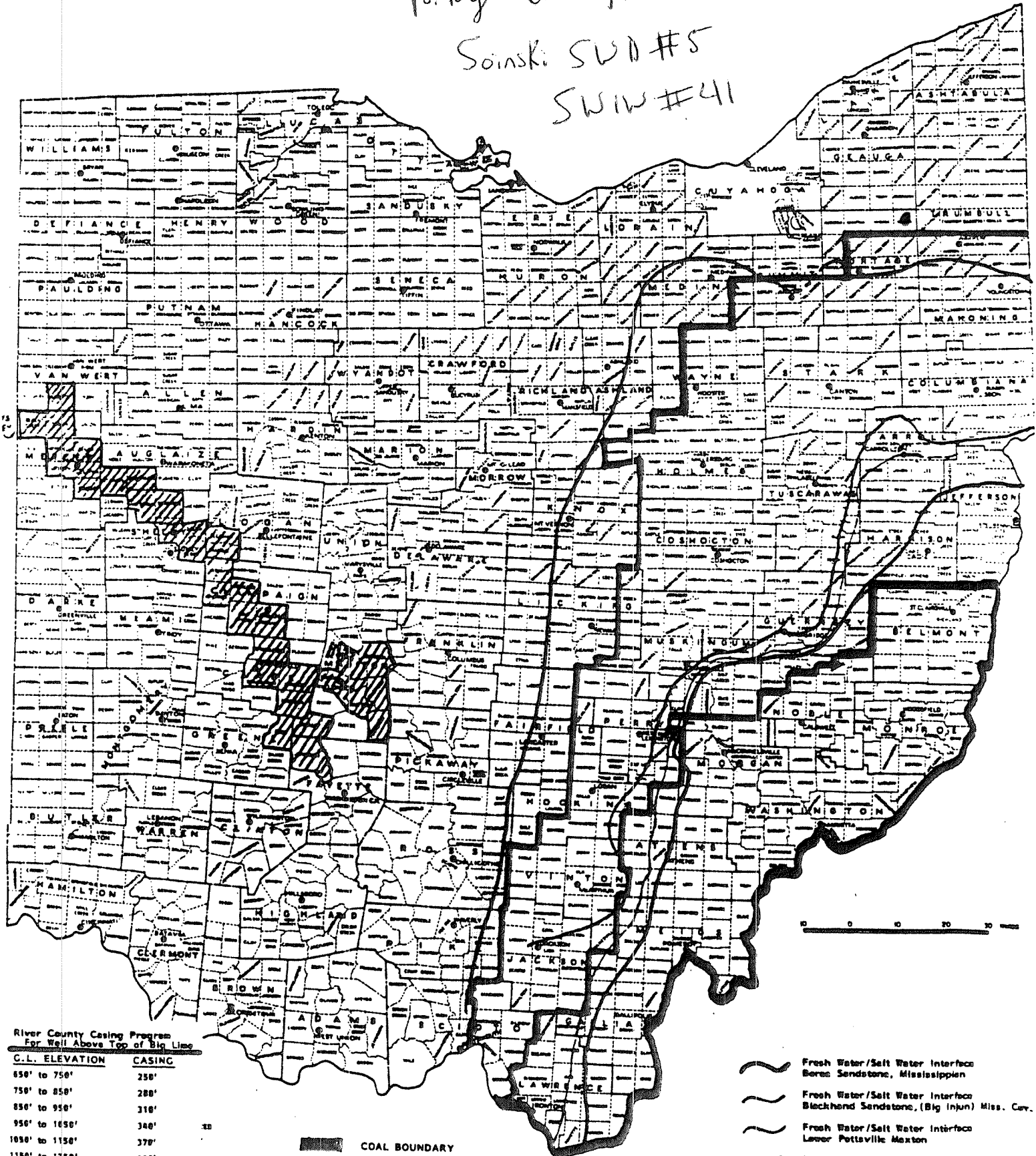

SWW #41



River County Casing Program  
For Well Above Top of Big Lime

C.L. ELEVATION	CASING
850' to 750'	250'
750' to 850'	288'
850' to 950'	318'
950' to 1050'	340'
1050' to 1150'	370'
1150' to 1250'	400'
1250' to 1350'	430'
OVER 1350'	500'

 COAL BOUNDARY

-  Fresh Water/Salt Water Interface  
Berea Sandstone, Missisippian
-  Fresh Water/Salt Water Interface  
Blackhand Sandstone, (Big Injun) Miss. Cov.
-  Fresh Water/Salt Water Interface  
Lower Pottsville Maxton
-  Fresh Water/Salt Water Interface  
Upper Allegheny 2nd Coe Run

Portage County, Nelson Top  
Sonski SWD #5 SWIW #41

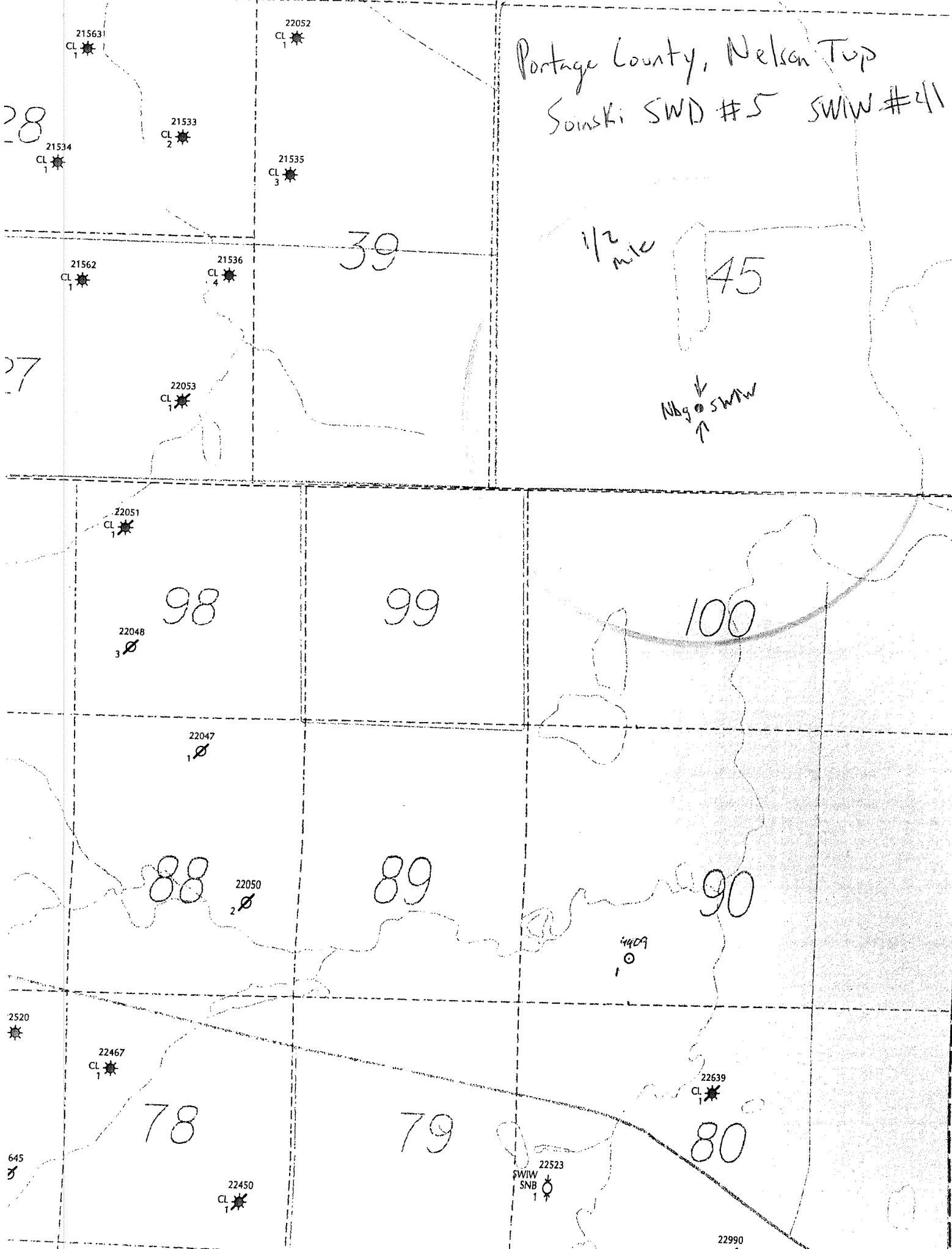

28  
215631  
CL 1  
21534  
CL 1

22052  
CL 1  
21533  
CL 2  
21535  
CL 3

27  
21562  
CL 1  
21536  
CL 4  
22053  
CL 1

39

1/2  
mile

45

Nbg  
SWW

22051  
CL 1

98  
22048  
3

99

100

22047  
1

88

22050  
2

89

90

4409  
1

2520

22467  
CL 1

78

79

22639  
CL 1

80

645

22450  
CL 1

22523  
SWIW  
SNB  
1

22990

P & A	FM	Permit Number	Casing/Cement Program	Well Log and/or Method of Plug
<input type="checkbox"/>			<u>Proposed</u>	<u>Newburg SW 1W 11 3/4" - 600' cement</u> <u>to surface 8 5/8" - 4000' cemented up to 2500'</u> <u>5 1/2" - 3900' packer @ 3900'</u>
<input type="checkbox"/>				
<input type="checkbox"/>				
<input type="checkbox"/>				
<input type="checkbox"/>				
<input type="checkbox"/>				
<input type="checkbox"/>				
<input type="checkbox"/>				
<input type="checkbox"/>				
<input type="checkbox"/>				
<input type="checkbox"/>				
<input type="checkbox"/>				
<input type="checkbox"/>				
<input type="checkbox"/>				
<input type="checkbox"/>				
<input type="checkbox"/>				
<input type="checkbox"/>				
<input type="checkbox"/>				
<input type="checkbox"/>				
<input type="checkbox"/>				
<input type="checkbox"/>				
<input type="checkbox"/>				
<input type="checkbox"/>				
<input type="checkbox"/>				
<input type="checkbox"/>				
<input type="checkbox"/>				

**NOTE:** Proposed injection well should be circumscribed with appropriate radius and all wells clearly labeled and identified. A legend depicting color code is requires.

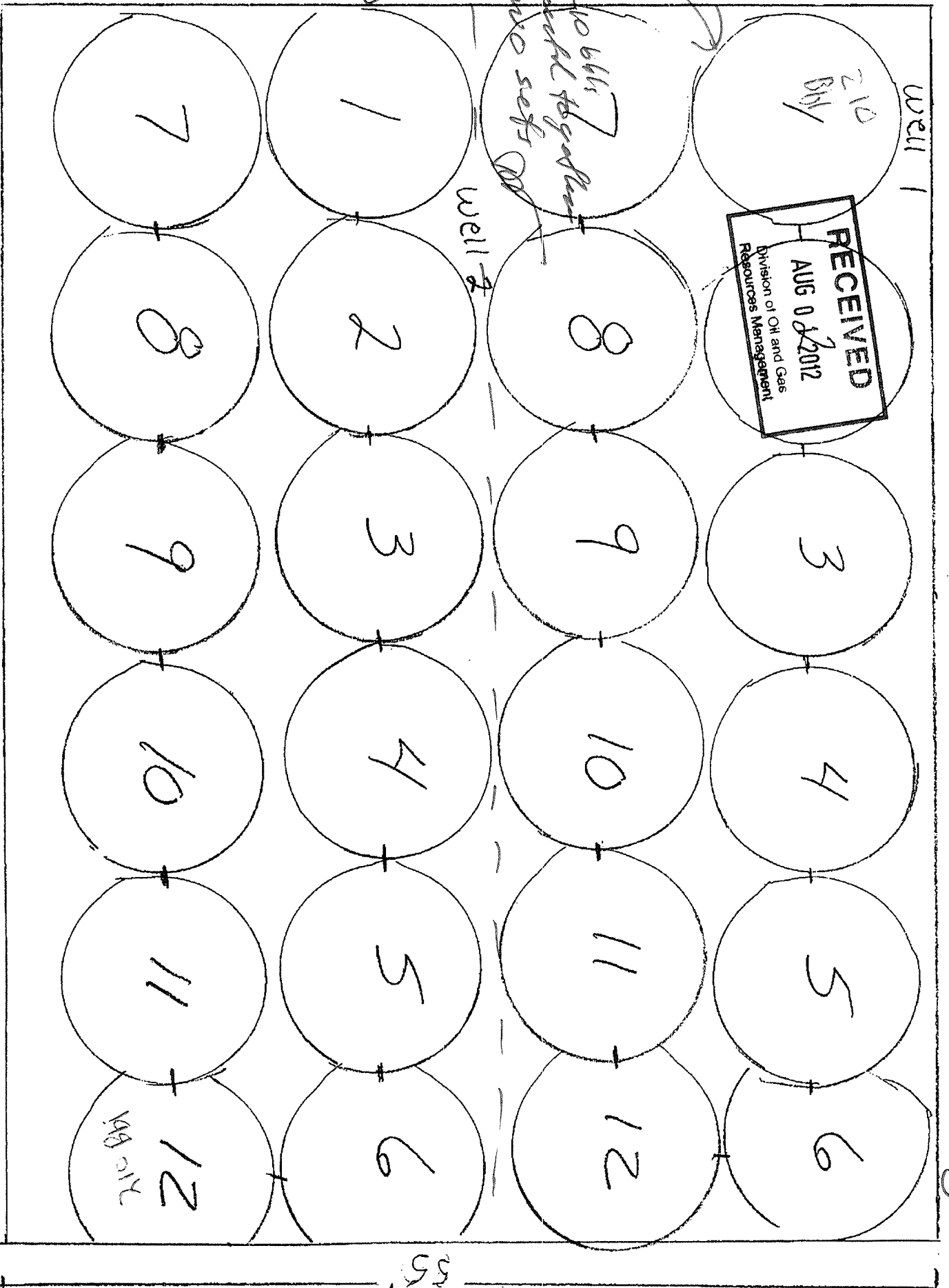

RECEIVED  
 AUG 0 2 2012  
 Division of Oil and Gas  
 Resources Management

12-210 bbls  
 Considered together  
 in two sets

Well 2

55'

MAB AIR

12 x 210 bbls  
 = 2520 bbls

85' x 55' x 0.0148 = 69.19 bbls. per inch x 40" in height

= 2767 bbls. capacity

**APPLICATION FOR A PERMIT (Form 1)**  
 OHIO DEPARTMENT OF NATURAL RESOURCES  
 DIVISION OF OIL AND GAS RESOURCES MANAGEMENT  
 2045 Morse Road, Building H-3  
 COLUMBUS, OHIO 43229-6693  
 (614) 265-6633

# 1160  
 \$1000<sup>00</sup>

APR # 020711

SEE INSTRUCTIONS ON PAGE 2 (BACK)

1. I, We (applicant) <u>Hard Rock Drilling &amp; Producing LLC</u> 2. Owner #: <u>8837</u>	
(address) <u>7646 Cedar Valley Road, West Salem, Ohio 44287</u> Phone #: <u>419-846-3850</u>	
hereby apply this date <u>4-Jun</u> , 20 <u>12</u> for a permit to:	
<input type="checkbox"/> Reissue (check appropriate blank)	<input type="checkbox"/> Revised Location
<input checked="" type="checkbox"/> Drill New Well	<input type="checkbox"/> Plug Back
<input type="checkbox"/> Drill Directionally	<input type="checkbox"/> Plug and Abandon
<input type="checkbox"/> Drill Horizontally	<input type="checkbox"/> Orphan Well Program
<input type="checkbox"/> Convert	<input type="checkbox"/> Deepen
<input type="checkbox"/> Reopen	<input type="checkbox"/> Temporary Inactive
3. TYPE OF WELL: <input type="checkbox"/> Oil & Gas <input type="checkbox"/> Annular Disposal <input type="checkbox"/> Saltwater Injection	
<input type="checkbox"/> Stratigraphic Test <input type="checkbox"/> Gas Storage <input type="checkbox"/> Other (explain): _____	
<input type="checkbox"/> Solution Mining* <input type="checkbox"/> Enhanced Recovery* (* if checked, select appropriate box below)	
<input checked="" type="checkbox"/> Input/Injection <input type="checkbox"/> Water Supply <input type="checkbox"/> Observation <input type="checkbox"/> Production/Extraction	
4. MAIL PERMIT TO: Hard Rock Drilling & Producing LLC, 7646 Cedar Valley Road, West Salem, Ohio 44287	20. TYPE OF TOOLS: <input type="checkbox"/> Cable <input type="checkbox"/> Air Rotary <input type="checkbox"/> Cable / Air Rotary <input checked="" type="checkbox"/> Air / Fluid Rotary <input type="checkbox"/> Cable / Fluid Rotary <input type="checkbox"/> Fluid Rotary <input type="checkbox"/> Cable / Air / Fluid Rotary <input type="checkbox"/> Service Rig
5. COUNTY: <u>Portage</u>	21. PROPOSED CASING PROGRAM:  16" Conductor cement to surface, 11 3/4 surface to <del>350'</del> <sup>600'</sup> cement to surface, 8 5/8 surface to <del>4200'</del> <sup>7000'</sup> 5 1/2 tubing set on packer within 100' of top of perf approximately 4000' <i>7000' AA</i>
6. CIVIL TOWNSHIP: <u>Nelson</u>	
7. SECTION: _____ 8. LOT: <u>45</u>	
9. FRACTION: _____ 10. QTR TWP: _____	
11. TRACT / ALLOT: _____	
12. WELL #: <u>5</u>	22. FIRE AND MEDICAL DEPARTMENT TELEPHONE NUMBERS: (closest to well site) Fire: <u>911</u> Medical: <u>911</u>
13. LEASE NAME: <u>Soinski</u>	
14. PROPOSED TOTAL DEPTH: <u>4200</u>	23. MEANS OF INGRESS & EGRESS: Township Road: _____ County Road: _____ Municipal Road: _____ State Highway: <u>St. Rt. 82</u>
15. PROPOSED GEOLOGICAL FORMATION: <u>Newburg</u>	
16. DRILLING UNIT IN ACRES (must be same as acres indicated on plat): <u>446.27</u>	
17. IF PERMITTED PREVIOUSLY: API #: _____ OWNER: _____ WELL #: _____ LEASE NAME: _____ TOTAL DEPTH: _____ GEOLOGICAL FORMATION: _____	24. IS THE WELL LOCATION OR PRODUCTION FACILITIES WITHIN AN URBANIZED AREA AS DEFINED BY 1509.01(Y) ? <input type="checkbox"/> Yes <input checked="" type="checkbox"/> No
18. IF SURFACE RIGHTS ARE OWNED BY THE OHIO DEPARTMENT OF NATURAL RESOURCES Division Name: _____ Division Phone: _____	
19. LANDOWNER ROYALTY INTEREST: Is There An Attached List? <input type="checkbox"/> Yes <input checked="" type="checkbox"/> No Name: <u>Dale Soinski</u> Address: <u>10218 Silica Sand Road, Garrettsville, Ohio 44231</u> Name: _____ Address: _____ Name: _____ Address: _____	

**RECEIVED**

JUN 07 2012

I, the undersigned, being first duly sworn, depose and state under penalties of law, that I am authorized to make this application, that this application was prepared by me or under my supervision and direction, and that the facts stated herein are true, correct, and complete, to the best of my knowledge.

I, the undersigned, further depose and state that I am the person who has the right to drill on the tract or drilling unit and to drill into and produce from a pool and to appropriate the oil or gas that I produce therefrom either for myself or others as described in this application. And furthermore, I the undersigned, being duly sworn, depose and state at this time that I am not liable for any final nonappealable order of a court for damage to streets, roads, highways, bridges, culverts, or drainage ways pursuant to Section 5577.12 of the Ohio Revised Code (ORC). I, the undersigned, further depose and state that all notices required by 1509.06 (A) (9) ORC for this application have been duly provided by me. If applying for a permit to plug and abandon a well, I hereby certify that the written notices, as required in Section 1509.13, ORC, have been given.

That I hereby agree to conform with all provisions of Chapter 1509., ORC, and Chapter 1501., OAC, and all orders and conditions issued by the Chief, Division of Oil and Gas Resources Management.

Signature of Owner/Authorized Agent Charles J. Cutter  
 Name (Type or Print) Charles J. Cutter Title Pres

If signed by Authorized Agent, a certificate of appointment of agent must be on file.

Sworn to and subscribed before me this the 4 day of June, 2012  
Kristin L. Anthony  
 (Notary Public)



Kristin L. Anthony  
 Notary Public, State of Ohio  
 My Commission Expires  
 April 3, 2017

April 3, 2017  
 (Date Commission Expires)

Before this application can be processed, an Authority and Organization Form (Form 9), indicating the exact owner name on this form, and proof of compliance with the surety and insurance requirements of Chapter 1509.07, Ohio Revised Code, must be on file with the Division of Oil and Gas Resources Management. The signature of owner/authorized agent must correspond with the signature(s) listed on the Form 9 on file with the Division.

All information requested on this form must be provided unless exempted by the instructions below. Incomplete applications may be returned to the applicant. An application for a permit requires the following:

**1. Drill, Reopen, Deepen and Plug Back an *Oil and Gas Well* (non-urban valid for 24 months; urban valid for 12 months)**

- a. Original and two (2) copies of Application for a Permit (Form 1);
- b. Original and four (4) copies of an Ohio registered surveyor's plat;
- c. Original and one (1) copy of the Restoration Plan (Form 4);
- d. Reopen, deepen, plug back and convert will require three (3) copies of the Well Completion Record (Form 8);
- e. \$500.00 check or money order payable to the Division of Oil and Gas Resources Management and;
- f. If requesting an expedited review, an additional \$250 fee is required; and an Oil & Gas Affidavit (if the proposed well location is in a coal-bearing township).
- g. For an **urbanized area** new well drilling permit, the fee is as follows: \$500 for a township with a population up to 9,999; \$750 for a township with a population of 10,000 to 14,999; \$1,000 for a township with a population exceeding 15,000; and \$1,000 for all municipal corporations regardless of population.
- h. For **mandatory pooling**, an additional \$5,000.

**2. Reissue or Revised Location**

- a. Same as above: 1(a), (b), (c), (d), (f);
- b. \$250 check or money order payable to the Division of Oil and Gas Resources Management.

**3. Plug and Abandon (valid for 24 months)**

- a. Original copy of Application for a Permit (Form 1);
- b. Two (2) copies of the Ohio registered surveyor's plat originally filed, or modified, if available;
- c. Three (3) copies of the Well Completion Record (Form 8) if available; if there is no Well Completion Record on file with the Division, provide any drilling information that is available;
- d. \$250 check or money order payable to the Division of Oil and Gas Resources Management;
- e. If requesting an expedited review, an additional \$500 fee is required.

**4. Drill, Reissue, Reopen, Deepen, Plug Back or Convert a Well to *Saltwater Injection***

- a. Same as above: 1(a), (b), (c), (d); and
- b. \$1,000 check or money order payable to the Division of Oil and Gas Resources Management.

**5. Temporary Inactive (valid for 12 months)**

- a. Original and one (1) copy of Application for a Permit (Form 1);
- b. A map, on a scale not smaller than four hundred feet to the inch, that shows the location of the well and the tank battery, that includes the latitude and longitude of the well;
- c. A written statement that the well is of future utility, and that there is a viable plan to use the well within a reasonable period of time and the well poses no threat to the health or safety of persons, property or the environment;
- d. For first application, \$100 check or money order payable to the Division of Oil and Gas Resources Management;
- e. For first renewal, \$250 check or money order payable to the Division of Oil and Gas Resources Management;
- f. For subsequent renewals, \$500 check or money order payable to the Division of Oil and Gas Resources Management; additional bonding may be required.

Item 1. Permit holder's name - as it appears on Form 9. Indicate the type of or combination of activities to be permitted.

Item 2. Indicate owner number, if the owner number is not known, please contact the Division.

Item 3. Indicate the type of well for which the application is being submitted.

Item 4. Provide name, address, city, state and zip code where the permit is to be mailed.

Items 5-11. Indicate drilling location.

Items 12-16. Provide requested information.

Item 17. Complete when application is for a permit to reopen, deepen, reissue, plug back, convert, or plug and abandon. If the well was never permitted, list "NONE" under permit #; all other wells require the permit number.

Item 18. Complete if surface rights are owned by the Ohio Department of Natural Resources.

Item 19. List names and addresses of all landowner royalty interest holders. Names must coincide with those shown on the designated unit or subject tract on the surveyor's plat or an explanation must be included. Additional sheets may be attached (overriding royalty and working interests are not required).

Item 20. Indicate type of tools that may be used.

Item 21. Indicate size and amount of casing to be used, and/or formations to be cased off.

Item 22. Indicate fire and medical department emergency telephone numbers closest to the well site.

Item 23. List all county, township, and/or municipal roads, streets and highways by name or number that applicant anticipates to use as means of ingress and egress to and from the well site.

Item 24. An "urbanized area" is a municipal corporation or a township that has an unincorporated population of more than five thousand, as defined under Section 1509.01 (Y) of the Ohio Revised Code. Notice must be provided by regular mail to the owner of each parcel of real property that is located within five hundred feet of the surface location of the well, and to either the executive authority of the municipal corporation or the board of township trustees (see 1509.06 (A) (9)).

**SUPPLEMENT TO APPLICATION**  
**PERMIT FOR AN ENHANCED RECOVERY PROJECT (Form 203)**

Ohio Department of Natural Resources, Division of Oil and Gas Resources Management  
2045 Morse Road, Bldg H3  
Columbus, OH 43229-6693

AREA OF REVIEW. An application for an Enhanced Recovery Project (ERP) will be evaluated on the basis of an "area of review" surrounding the proposed input wells for the project. The area of review for projects in which injection of greater than two hundred barrels per day per well is proposed shall be the area circumscribed by a circle with one center point at the location of each input well and a radius of one-half mile. The area of review for projects in which a maximum injection of two hundred barrels per day per well or less is proposed shall be the area circumscribed by a circle with the center point at the location of each input well and a radius of one-quarter mile. Projects in which gas is the proposed injection fluid will have an area of review consisting of an area circumscribed by a circle with the center point at the location of each input well and a radius of one-quarter mile.

31. **PROPOSED INJECTION ZONE**

Geological Formation: \_\_\_\_\_ Newburg  
Injection Interval: From: ~~4050~~ <sup>4000' AA</sup> feet to 4200  
Geologic description of injection zone: \_\_\_\_\_

32. **WELL CONSTRUCTION AND OPERATION**

A. Description of the proposed casing and cement program for new wells, or of the casing, cementing or sealing with prepared clay for existing wells to be converted:  
1 1/4 casing surface to 600', 8 5/8 casing surface to TD approx 4200' cemented to surface, 5 1/2 tubing set on packer at approx. 4000'

B. Proposed method for testing the casing:  
Pressure test to be done after cementing of longstring and before perforation of longstring. Pressure up on longstring

C. Description of the proposed method for completion and operation of the injection well:  
5 1/2 tubing set on a packer at approx. 4000'

D. Description of the proposed unloading, surface storage, and spill containment facilities:  
The unloading area will be concrete with a concrete vault to hold any spillage. The water will be stored in 210 or 400 BBL tanks which will be placed on a concrete pad with concrete walls. This dike will be of sufficient size to contain all water in case of tank failure.  
Trucks will unload through a strainer/ filter into the tanke. Water will be filtered to the injection pump.

~~RECEIVED~~

33. **PROPOSED INJECTION VOLUMES**

A. Indicate the estimated amount of saltwater to be injected into the proposed injection well per day:  
AVERAGE: 800 MAXIMUM: 1600

B. Indicate the method to be used to measure the actual amount of saltwater injected into the well:  
Paperwork turned in by drivers. Electronics on unload station to monitor trucks & amount of water with flowmeter

34. **PROPOSED INJECTION PRESSURES**

A. Indicate the estimated pressure to be used for injection of saltwater into the proposed injection well:  
AVERAGE: 800 MAXIMUM: 1000 920 psi

B. Indicate the method to be used to measure the actual daily injection pressure:  
Guages on wellhead recorded be well tender and electronics on the well with tranducers AA

35. **PROPOSED CORRECTIVE ACTION**

Explain any corrective action proposed for wells penetrating the proposed injection formation or zone within the area of review.  
The only well within the area of review is an existing disposal well



36. **MAP.** Each application for a permit shall be accompanied by a map or maps showing and containing the following information:
- A. The subject area trace or tracts of land and their owners upon which the proposed enhanced recovery operations are to be conducted;
  - B. The location and designation of all input, withdrawal, or observation wells on the tract or tracts to be utilized in the enhanced recovery project.
  - C. The geographic location of all wells, penetrating the formation proposed for injection regardless of status, within the area of review;
  - D. All holders of the land owner's royalty interest of record, or holders of the severed oil and gas mineral estates of record in the subject area.
  - E. All owners or operators of wells producing from or injecting into the same formation proposed as the injection formation.

37. **SCHEMATIC DRAWING OF SUBSURFACE CONSTRUCTION.** Label the schematic drawing below indicating size and setting depth of surface casing, intermediate (if any) and production casings; amount of cement used, measured or calculated tops of cement; size and setting depth of tubing; type and setting depth of packer; geologic name of injection zone showing top and bottom of injection interval. If the proposed input well design is substantially different from the schematic below, attach on a separate sheet a schematic of your proposal labeled with the above information.

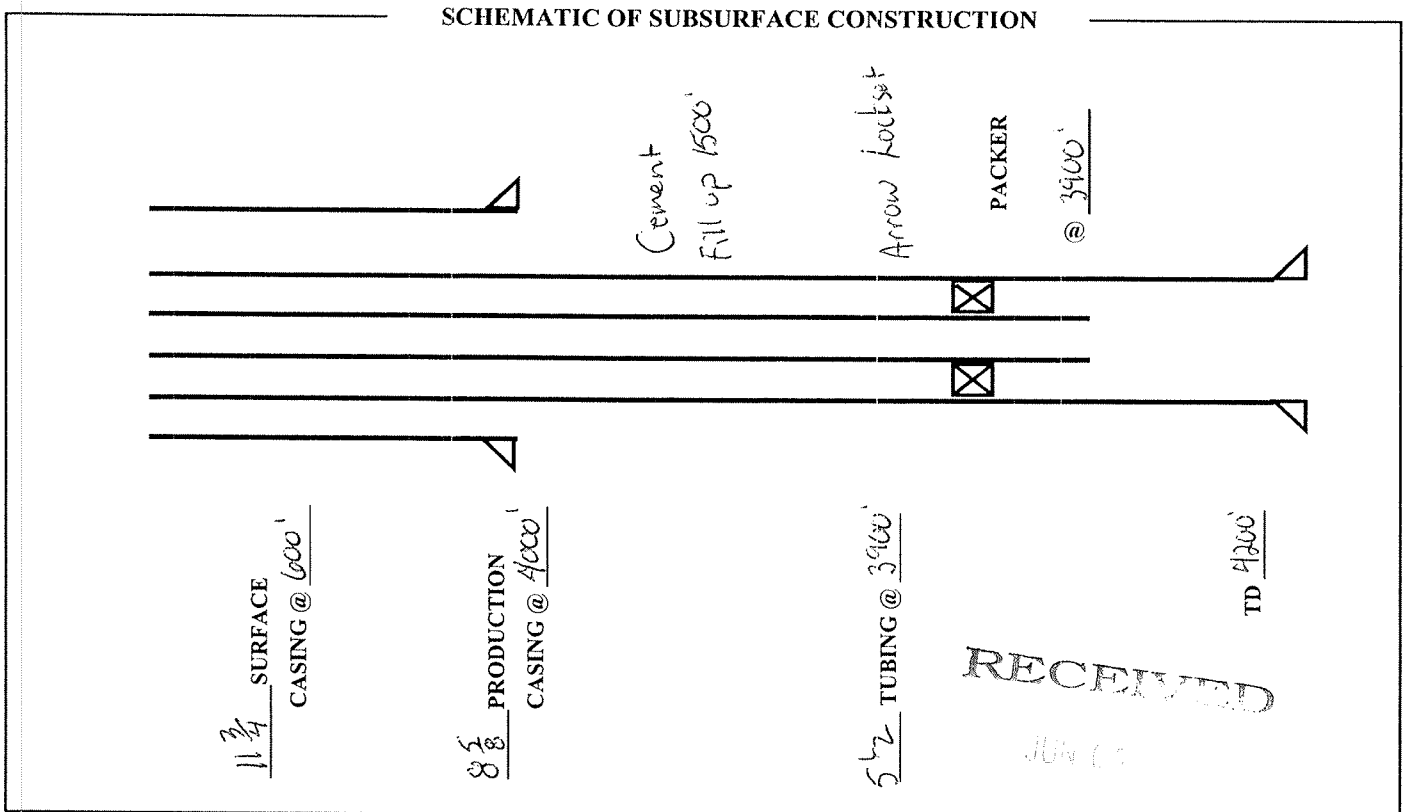

38. Public notice of an application for an enhanced recovery project is required by law. In addition, the applicant must submit, on an attached sheet, a list of the names and address of those persons required to receive personal notice in accordance with Rule 1501:9-5-05(E)(1), of the Ohio Administrative Code.

After submitting the application, and after a determination by the Division that it is complete as required by the rules of the Division, a legal notice must be published by the applicant in a newspaper of general circulation in the area of review. The legal notice must contain the information described in Rule 1501:9-5-05(E)(1) of the Ohio Administrative Code. A copy of the notice must be delivered to all owners or operators of wells within the area of review producing from or injecting into the same formation proposed as the injection formation. Proof of publication, publication date, and an oath as to the delivery to those entitled to receive personal notice under this method must be filed with the Division within thirty days after the Division determines that the application is complete.

In addition, notice of all applications for enhanced recovery projects will be published in the Division's Weekly Circular.

The undersigned hereby agrees to comply with all provisions for an enhanced recovery project as required by Chapter 1501:9-5 of the Ohio Administrative Code. In addition, the undersigned deposed and says that he shall conform to all provisions of Section 1509.072 of the Ohio Revised Code, and to all orders and rules issued by the Chief, Division of Oil and Gas Resources Management.

Owner/Authorized Agent (Type or Print): Charles J Cutler  
 Signature of Owner/Authorized Agent: [Signature] Title: Pres  
 Permanent Address of Home Office: 76416 Cedar Valley Rd W. Salem, OH 44287

If signed by Authorized Agent, a certified copy of appointment of agent must be on file with the Division.

SWORN to and subscribed before me this 4 day of June, 2012.



(SEAL) Kristin L. Anthony  
 Notary Public, State of Ohio  
 My Commission Expires  
 April 3, 2017

Kristin L. Anthony  
 Notary Public  
April 3, 2017  
 Date Commission Expires

**Subsurface Construction  
For Injection Well**

**Maximum Injection Pressure: 920 psi**

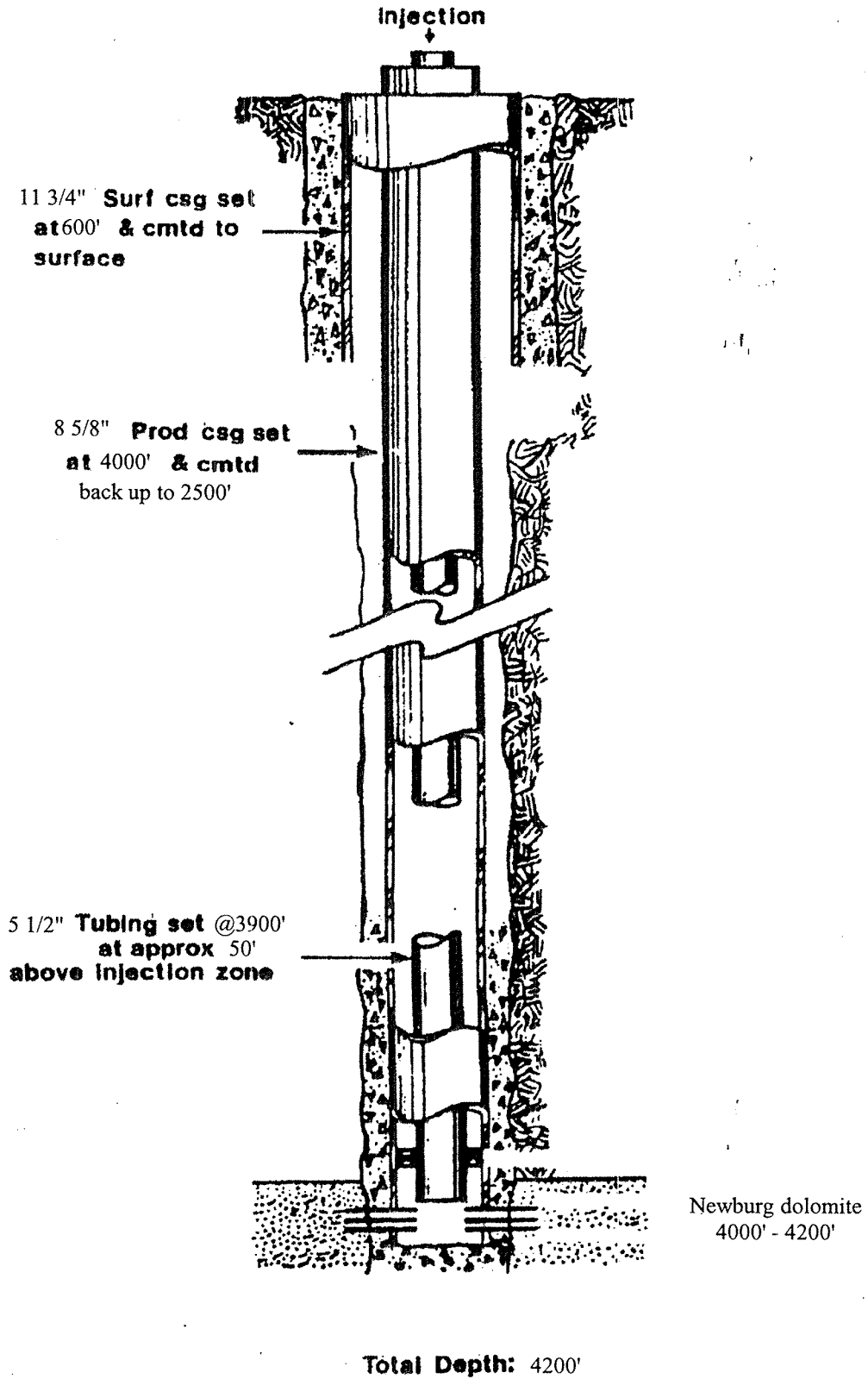

**APPLICATION FOR A PERMIT (Form 1)**  
 OHIO DEPARTMENT OF NATURAL RESOURCES  
 DIVISION OF OIL AND GAS RESOURCES MANAGEMENT  
 2045 Morse Road, Building H-3  
 COLUMBUS, OHIO 43229-6693  
 (614) 265-6633

**SEE INSTRUCTIONS ON PAGE 2 (BACK)**

1. I, We (applicant) <u>Hard Rock Drilling &amp; Producing LLC</u> 2. Owner #: <u>8837</u>	
(address) <u>7646 Cedar Valley Road, West Salem, Ohio 44287</u> Phone #: <u>419-846-3850</u>	
hereby apply this date <u>4 Jun</u> , 20 <u>12</u> for a permit to:	
<input type="checkbox"/> Reissue (check appropriate blank)	<input type="checkbox"/> Revised Location
<input checked="" type="checkbox"/> Drill New Well	<input type="checkbox"/> Plug Back
<input type="checkbox"/> Drill Directionally	<input type="checkbox"/> Plug and Abandon
<input type="checkbox"/> Drill Horizontally	<input type="checkbox"/> Orphan Well Program
<input type="checkbox"/> Convert	<input type="checkbox"/> Deepen
<input type="checkbox"/> Reopen	<input type="checkbox"/> Temporary Inactive
3. TYPE OF WELL: <input type="checkbox"/> Oil & Gas <input type="checkbox"/> Annular Disposal <input type="checkbox"/> Saltwater Injection	
<input type="checkbox"/> Stratigraphic Test <input type="checkbox"/> Gas Storage <input type="checkbox"/> Other (explain): _____	
<input type="checkbox"/> Solution Mining* <input type="checkbox"/> Enhanced Recovery* (* if checked, select appropriate box below)	
<input checked="" type="checkbox"/> Input/Injection <input type="checkbox"/> Water Supply <input type="checkbox"/> Observation <input type="checkbox"/> Production/Extraction	
4. MAIL PERMIT TO: Hard Rock Drilling & Producing LLC, 7646 Cedar Valley Road, West Salem, Ohio 44287	20. TYPE OF TOOLS: <input type="checkbox"/> Cable <input type="checkbox"/> Air Rotary <input type="checkbox"/> Cable / Air Rotary <input checked="" type="checkbox"/> Air / Fluid Rotary <input type="checkbox"/> Cable / Fluid Rotary <input type="checkbox"/> Fluid Rotary <input type="checkbox"/> Cable / Air / Fluid Rotary <input type="checkbox"/> Service Rig
5. COUNTY: <u>Portage</u>	21. PROPOSED CASING PROGRAM:  16" Conductor cement to surface, 11 3/4 surface to <sup>6000</sup> 350' cement to surface, 8 5/8 surface to <del>4200</del> 4200', 5 1/2 tubing set on packer within 100' of top of perf approximately 4000'  <i>W.D. RA</i>
6. CIVIL TOWNSHIP: <u>Nelson</u>	
7. SECTION: _____ 8. LOT: <u>45</u>	
9. FRACTION: _____ 10. QTR TWP: _____	
11. TRACT / ALLOT: _____	
12. WELL #: <u>5</u>	
13. LEASE NAME: <u>Soinski</u>	22. FIRE AND MEDICAL DEPARTMENT TELEPHONE NUMBERS: (closest to well site) Fire: <u>911</u> Medical: <u>911</u>
14. PROPOSED TOTAL DEPTH: <u>4200</u>	
15. PROPOSED GEOLOGICAL FORMATION: <u>Newburg</u>	23. MEANS OF INGRESS & EGRESS: Township Road: _____ County Road: _____ Municipal Road: _____ State Highway: <u>St. Rt. 82</u>
16. DRILLING UNIT IN ACRES (must be same as acres indicated on plat): <u>446.27</u>	
17. IF PERMITTED PREVIOUSLY: API #: _____ OWNER: _____ WELL #: _____ LEASE NAME: _____ TOTAL DEPTH: _____ GEOLOGICAL FORMATION: _____	24. IS THE WELL LOCATION OR PRODUCTION FACILITIES WITHIN AN URBANIZED AREA AS DEFINED BY 1509.01(Y) ? <input type="checkbox"/> Yes <input checked="" type="checkbox"/> No <b>RECEIVED</b>
18. IF SURFACE RIGHTS ARE OWNED BY THE OHIO DEPARTMENT OF NATURAL RESOURCES Division Name: _____ Division Phone: _____	
19. LANDOWNER ROYALTY INTEREST: Is There An Attached List? <input type="checkbox"/> Yes <input checked="" type="checkbox"/> No Name: <u>Dale Soinski</u> Address: <u>10218 Silica Sand Road, Garrettsville, Ohio 44231</u> Name: _____ Address: _____ Name: _____ Address: _____	

I, the undersigned, being first duly sworn, depose and state under penalties of law, that I am authorized to make this application, that this application was prepared by me or under my supervision and direction, and that the facts stated herein are true, correct, and complete, to the best of my knowledge.

I, the undersigned, further depose and state that I am the person who has the right to drill on the tract or drilling unit and to drill into and produce from a pool and to appropriate the oil or gas that I produce therefrom either for myself or others as described in this application. And furthermore, I the undersigned, being duly sworn, depose and state at this time that I am not liable for any final nonappealable order of a court for damage to streets, roads, highways, bridges, culverts, or drainage ways pursuant to Section 5577.12 of the Ohio Revised Code (ORC). I, the undersigned, further depose and state that all notices required by 1509.06 (A) (9) ORC for this application have been duly provided by me. If applying for a permit to plug and abandon a well, I hereby certify that the written notices, as required in Section 1509.13, ORC, have been given.

That I hereby agree to conform with all provisions of Chapter 1509., ORC, and Chapter 1501., OAC, and all orders and conditions issued by the Chief, Division of Oil and Gas Resources Management.

Signature of Owner/Authorized Agent *Charles A. Carter*  
 Name (Type or Print) Charles A. Carter Title Pres

If signed by Authorized Agent, a certificate of appointment of agent must be on file.

Sworn to and subscribed before me this the 4 day of June, 2012



Kristin L. Anthony  
 Notary Public, State of Ohio  
 My Commission Expires  
 April 3, 2017

*Kristin L. Anthony*  
 (Notary Public)

April 3, 2017  
 (Date Commission Expires)

Before this application can be processed, an Authority and Organization Form (Form 9), indicating the exact owner name on this form, and proof of compliance with the surety and insurance requirements of Chapter 1509.07, Ohio Revised Code, must be on file with the Division of Oil and Gas Resources Management. The signature of owner/authorized agent must correspond with the signature(s) listed on the Form 9 on file with the Division.

All information requested on this form must be provided unless exempted by the instructions below. Incomplete applications may be returned to the applicant. An application for a permit requires the following:

**1. Drill, Reopen, Deepen and Plug Back an Oil and Gas Well (non-urban valid for 24 months; urban valid for 12 months)**

- a. Original and two (2) copies of Application for a Permit (Form 1);
- b. Original and four (4) copies of an Ohio registered surveyor's plat;
- c. Original and one (1) copy of the Restoration Plan (Form 4);
- d. Reopen, deepen, plug back and convert will require three (3) copies of the Well Completion Record (Form 8);
- e. \$500.00 check or money order payable to the Division of Oil and Gas Resources Management and;
- f. If requesting an expedited review, an additional \$250 fee is required; and an Oil & Gas Affidavit (if the proposed well location is in a coal-bearing township).
- g. For an **urbanized area** new well drilling permit, the fee is as follows: \$500 for a township with a population up to 9,999; \$750 for a township with a population of 10,000 to 14,999; \$1,000 for a township with a population exceeding 15,000; and \$1,000 for all municipal corporations regardless of population.
- h. For **mandatory pooling**, an additional \$5,000.

**2. Reissue or Revised Location**

- a. Same as above: 1(a), (b), (c), (d), (f);
- b. \$250 check or money order payable to the Division of Oil and Gas Resources Management.

**3. Plug and Abandon (valid for 24 months)**

- a. Original copy of Application for a Permit (Form 1);
- b. Two (2) copies of the Ohio registered surveyor's plat originally filed, or modified, if available;
- c. Three (3) copies of the Well Completion Record (Form 8) if available; if there is no Well Completion Record on file with the Division, provide any drilling information that is available;
- d. \$250 check or money order payable to the Division of Oil and Gas Resources Management;
- e. If requesting an expedited review, an additional \$500 fee is required.

**4. Drill, Reissue, Reopen, Deepen, Plug Back or Convert a Well to Saltwater Injection**

- a. Same as above: 1(a), (b), (c), (d); and
- b. \$1,000 check or money order payable to the Division of Oil and Gas Resources Management.

**5. Temporary Inactive (valid for 12 months)**

- a. Original and one (1) copy of Application for a Permit (Form 1);
- b. A map, on a scale not smaller than four hundred feet to the inch, that shows the location of the well and the tank battery, that includes the latitude and longitude of the well;
- c. A written statement that the well is of future utility, and that there is a viable plan to use the well within a reasonable period of time and the well poses no threat to the health or safety of persons, property or the environment;
- d. For first application, \$100 check or money order payable to the Division of Oil and Gas Resources Management;
- e. For first renewal, \$250 check or money order payable to the Division of Oil and Gas Resources Management;
- f. For subsequent renewals, \$500 check or money order payable to the Division of Oil and Gas Resources Management; additional bonding may be required.

Item 1. Permit holder's name - as it appears on Form 9. Indicate the type of or combination of activities to be permitted.

Item 2. Indicate owner number, if the owner number is not known, please contact the Division.

Item 3. Indicate the type of well for which the application is being submitted.

Item 4. Provide name, address, city, state and zip code where the permit is to be mailed.

Items 5-11. Indicate drilling location.

Items 12-16. Provide requested information.

Item 17. Complete when application is for a permit to reopen, deepen, reissue, plug back, convert, or plug and abandon. If the well was never permitted, list "NONE" under permit #; all other wells require the permit number.

Item 18. Complete if surface rights are owned by the Ohio Department of Natural Resources.

Item 19. List names and addresses of all landowner royalty interest holders. Names must coincide with those shown on the designated unit or subject tract on the surveyor's plat or an explanation must be included. Additional sheets may be attached (overriding royalty and working interests are not required).

Item 20. Indicate type of tools that may be used.

Item 21. Indicate size and amount of casing to be used, and/or formations to be cased off.

Item 22. Indicate fire and medical department emergency telephone numbers closest to the well site.

Item 23. List all county, township, and/or municipal roads, streets and highways by name or number that applicant anticipates to use as means of ingress and egress to and from the well site.

Item 24. An "urbanized area" is a municipal corporation or a township that has an unincorporated population of more than than five thousand, as defined under Section 1509.01 (Y) of the Ohio Revised Code. Notice must be provided by regular mail to the owner of each parcel of real property that is located within five hundred feet of the surface location of the well, and to either the executive authority of the municipal corporation or the board of township trustees (see 1509.06 (A) (9)).

**APPLICATION FOR A PERMIT (Form 1)**  
 OHIO DEPARTMENT OF NATURAL RESOURCES  
 DIVISION OF OIL AND GAS RESOURCES MANAGEMENT  
 2045 Morse Road, Building H-3  
 COLUMBUS, OHIO 43229-6693  
 (614) 265-6633

**SEE INSTRUCTIONS ON PAGE 2 (BACK)**

1. I, We (applicant) <u>Hard Rock Drilling &amp; Producing LLC</u> 2. Owner #: <u>8837</u>	
(address) <u>7646 Cedar Valley Road, West Salem, Ohio 44287</u> Phone #: <u>419-846-3850</u>	
hereby apply this date <u>4-Jun</u> , 20 <u>12</u> for a permit to:	
<input type="checkbox"/> Reissue (check appropriate blank)	<input type="checkbox"/> Revised Location
<input checked="" type="checkbox"/> Drill New Well	<input type="checkbox"/> Plug Back
<input type="checkbox"/> Drill Directionally	<input type="checkbox"/> Plug and Abandon
<input type="checkbox"/> Drill Horizontally	<input type="checkbox"/> Orphan Well Program
<input type="checkbox"/> Convert	<input type="checkbox"/> Deepen
<input type="checkbox"/> Reopen	<input type="checkbox"/> Temporary Inactive
3. TYPE OF WELL:	
<input type="checkbox"/> Oil & Gas	<input type="checkbox"/> Annular Disposal
<input type="checkbox"/> Stratigraphic Test	<input type="checkbox"/> Gas Storage
<input type="checkbox"/> Solution Mining*	<input type="checkbox"/> Enhanced Recovery* (* if checked, select appropriate box below)
<input checked="" type="checkbox"/> Input/Injection	<input type="checkbox"/> Water Supply
<input type="checkbox"/> Saltwater Injection	<input type="checkbox"/> Other (explain): _____
<input type="checkbox"/> Observation	<input type="checkbox"/> Production/Extraction
4. MAIL PERMIT TO: Hard Rock Drilling & Producing LLC, 7646 Cedar Valley Road, West Salem, Ohio 44287	20. TYPE OF TOOLS:
	<input type="checkbox"/> Cable
	<input type="checkbox"/> Cable / Air Rotary
	<input type="checkbox"/> Cable / Fluid Rotary
	<input type="checkbox"/> Cable / Air / Fluid Rotary
	<input type="checkbox"/> Air Rotary
	<input checked="" type="checkbox"/> Air / Fluid Rotary
	<input type="checkbox"/> Fluid Rotary
	<input type="checkbox"/> Service Rig
5. COUNTY: <u>Portage</u>	21. PROPOSED CASING PROGRAM:  16" Conductor cement to surface, 11 3/4 surface to <sup>600' AA</sup> 350' cement to surface, 8 5/8 surface to <sup>4200'</sup> 4200', 5 1/2 tubing set on packer within 100' of top of perf approximately 4000'  <i>4200' AA</i>
6. CIVIL TOWNSHIP: <u>Nelson</u>	
7. SECTION: _____ 8. LOT: <u>45</u>	
9. FRACTION: _____ 10. QTR TWP: _____	
11. TRACT / ALLOT: _____	
12. WELL #: <u>5</u>	
13. LEASE NAME: <u>Soinski</u>	
14. PROPOSED TOTAL DEPTH: <u>4200</u>	
15. PROPOSED GEOLOGICAL FORMATION: <u>Newburg</u>	
16. DRILLING UNIT IN ACRES (must be same as acres indicated on plat): <u>446.27</u>	
17. IF PERMITTED PREVIOUSLY:	22. FIRE AND MEDICAL DEPARTMENT TELEPHONE NUMBERS: (closest to well site)
API #: _____	Fire: <u>911</u>
OWNER: _____	Medical: <u>911</u>
WELL #: _____	23. MEANS OF INGRESS & EGRESS:
LEASE NAME: _____	Township Road: _____
TOTAL DEPTH: _____	County Road: _____
GEOLOGICAL FORMATION: _____	Municipal Road: _____
18. IF SURFACE RIGHTS ARE OWNED BY THE OHIO DEPARTMENT OF NATURAL RESOURCES	State Highway: <u>St. Rt. 82</u>
Division Name: _____	24. IS THE WELL LOCATION OR PRODUCTION FACILITIES WITHIN AN URBANIZED AREA AS DEFINED BY 1509.01(Y) ?
Division Phone: _____	<input type="checkbox"/> Yes <input checked="" type="checkbox"/> No
19. LANDOWNER ROYALTY INTEREST:	<b>RECEIVED</b>
Is There An Attached List? <input type="checkbox"/> Yes <input checked="" type="checkbox"/> No	JUN 07 2012
Name: <u>Dale Soinski</u>	
Address: <u>10218 Silica Sand Road, Garrettsville, Ohio 44231</u>	
Name: _____	
Address: _____	
Name: _____	
Address: _____	

I, the undersigned, being first duly sworn, depose and state under penalties of law, that I am authorized to make this application, that this application was prepared by me or under my supervision and direction, and that the facts stated herein are true, correct, and complete, to the best of my knowledge.

I, the undersigned, further depose and state that I am the person who has the right to drill on the tract or drilling unit and to drill into and produce from a pool and to appropriate the oil or gas that I produce therefrom either for myself or others as described in this application. And furthermore, I the undersigned, being duly sworn, depose and state at this time that I am not liable for any final nonappealable order of a court for damage to streets, roads, highways, bridges, culverts, or drainage ways pursuant to Section 5577.12 of the Ohio Revised Code (ORC). I, the undersigned, further depose and state that all notices required by 1509.06 (A) (9) ORC for this application have been duly provided by me. If applying for a permit to plug and abandon a well, I hereby certify that the written notices, as required in Section 1509.13, ORC, have been given.

That I hereby agree to conform with all provisions of Chapter 1509., ORC, and Chapter 1501., OAC, and all orders and conditions issued by the Chief, Division of Oil and Gas Resources Management.

Signature of Owner/Authorized Agent *Charles J. Cutter*  
 Name (Type or Print) Charles J. Cutter Title Pres

If signed by Authorized Agent, a certificate of appointment of agent must be on file.

Sworn to and subscribed before me this the 4 day of June, 2012

 Kristin L. Anthony  
 Notary Public, State of Ohio  
 My Commission Expires  
 April 3, 2017

*Kristin L. Anthony*  
 (Notary Public)

April 3, 2017  
 (Date Commission Expires)

Before this application can be processed, an Authority and Organization Form (Form 9), indicating the exact owner name on this form, and proof of compliance with the surety and insurance requirements of Chapter 1509.07, Ohio Revised Code, must be on file with the Division of Oil and Gas Resources Management. The signature of owner/authorized agent must correspond with the signature(s) listed on the Form 9 on file with the Division.

All information requested on this form must be provided unless exempted by the instructions below. Incomplete applications may be returned to the applicant. An application for a permit requires the following:

**1. Drill, Reopen, Deepen and Plug Back an Oil and Gas Well (non-urban valid for 24 months; urban valid for 12 months)**

- a. Original and two (2) copies of Application for a Permit (Form 1);
- b. Original and four (4) copies of an Ohio registered surveyor's plat;
- c. Original and one (1) copy of the Restoration Plan (Form 4);
- d. Reopen, deepen, plug back and convert will require three (3) copies of the Well Completion Record (Form 8);
- e. \$500.00 check or money order payable to the Division of Oil and Gas Resources Management and;
- f. If requesting an expedited review, an additional \$250 fee is required; and an Oil & Gas Affidavit (if the proposed well location is in a coal-bearing township).
- g. For an **urbanized area** new well drilling permit, the fee is as follows: \$500 for a township with a population up to 9,999; \$750 for a township with a population of 10,000 to 14,999; \$1,000 for a township with a population exceeding 15,000; and \$1,000 for all municipal corporations regardless of population.
- h. For **mandatory pooling**, an additional \$5,000.

**2. Reissue or Revised Location**

- a. Same as above: 1(a), (b), (c), (d), (f);
- b. \$250 check or money order payable to the Division of Oil and Gas Resources Management.

**3. Plug and Abandon (valid for 24 months)**

- a. Original copy of Application for a Permit (Form 1);
- b. Two (2) copies of the Ohio registered surveyor's plat originally filed, or modified, if available;
- c. Three (3) copies of the Well Completion Record (Form 8) if available; if there is no Well Completion Record on file with the Division, provide any drilling information that is available;
- d. \$250 check or money order payable to the Division of Oil and Gas Resources Management;
- e. If requesting an expedited review, an additional \$500 fee is required.

**4. Drill, Reissue, Reopen, Deepen, Plug Back or Convert a Well to Saltwater Injection**

- a. Same as above: 1(a), (b), (c), (d); and
- b. \$1,000 check or money order payable to the Division of Oil and Gas Resources Management.

**5. Temporary Inactive (valid for 12 months)**

- a. Original and one (1) copy of Application for a Permit (Form 1);
- b. A map, on a scale not smaller than four hundred feet to the inch, that shows the location of the well and the tank battery, that includes the latitude and longitude of the well;
- c. A written statement that the well is of future utility, and that there is a viable plan to use the well within a reasonable period of time and the well poses no threat to the health or safety of persons, property or the environment;
- d. For first application, \$100 check or money order payable to the Division of Oil and Gas Resources Management;
- e. For first renewal, \$250 check or money order payable to the Division of Oil and Gas Resources Management;
- f. For subsequent renewals, \$500 check or money order payable to the Division of Oil and Gas Resources Management; additional bonding may be required.

Item 1. Permit holder's name - as it appears on Form 9. Indicate the type of or combination of activities to be permitted.

Item 2. Indicate owner number, if the owner number is not known, please contact the Division.

Item 3. Indicate the type of well for which the application is being submitted.

Item 4. Provide name, address, city, state and zip code where the permit is to be mailed.

Items 5-11. Indicate drilling location.

Items 12-16. Provide requested information.

Item 17. Complete when application is for a permit to reopen, deepen, reissue, plug back, convert, or plug and abandon. If the well was never permitted, list "NONE" under permit #; all other wells require the permit number.

Item 18. Complete if surface rights are owned by the Ohio Department of Natural Resources.

Item 19. List names and addresses of all landowner royalty interest holders. Names must coincide with those shown on the designated unit or subject tract on the surveyor's plat or an explanation must be included. Additional sheets may be attached (overriding royalty and working interests are not required).

Item 20. Indicate type of tools that may be used.

Item 21. Indicate size and amount of casing to be used, and/or formations to be cased off.

Item 22. Indicate fire and medical department emergency telephone numbers closest to the well site.

Item 23. List all county, township, and/or municipal roads, streets and highways by name or number that applicant anticipates to use as means of ingress and egress to and from the well site.

Item 24. An "urbanized area" is a municipal corporation or a township that has an unincorporated population of more than than five thousand, as defined under Section 1509.01 (Y) of the Ohio Revised Code. Notice must be provided by regular mail to the owner of each parcel of real property that is located within five hundred feet of the surface location of the well, and to either the executive authority of the municipal corporation or the board of township trustees (see 1509.06 (A) (9)).

**SUPPLEMENT TO APPLICATION**  
**PERMIT FOR AN ENHANCED RECOVERY PROJECT (Form 203)**

Ohio Department of Natural Resources, Division of Oil and Gas Resources Management  
2045 Morse Road, Bldg H3  
Columbus, OH 43229-6693

AREA OF REVIEW. An application for an Enhanced Recovery Project (ERP) will be evaluated on the basis of an "area of review" surrounding the proposed input wells for the project. The area of review for projects in which injection of greater than two hundred barrels per day per well is proposed shall be the area circumscribed by a circle with one center point at the location of each input well and a radius of one-half mile. The area of review for projects in which a maximum injection of two hundred barrels per day per well or less is proposed shall be the area circumscribed by a circle with the center point at the location of each input well and a radius of one-quarter mile. Projects in which gas is the proposed injection fluid will have an area of review consisting of an area circumscribed by a circle with the center point at the location of each input well and a radius of one-quarter mile.

31. **PROPOSED INJECTION ZONE**

Geological Formation: \_\_\_\_\_ Newburg  
Injection Interval: From: ~~4070~~ 4000' AA feet to 4200  
Geologic description of injection zone: \_\_\_\_\_

32. **WELL CONSTRUCTION AND OPERATION**

A. Description of the proposed casing and cement program for new wells, or of the casing, cementing or sealing with prepared clay for existing wells to be converted: 21600 AA  
1 1/4 casing surface to 600', 8 5/8 casing surface to TD approx. 4200' cemented to surface, 5 1/2 tubing set on packer at approx. 4000'

B. Proposed method for testing the casing:  
Pressure test to be done after cementing of longstring and before perforation of longstring. Pressure up on longstring

C. Description of the proposed method for completion and operation of the injection well:  
5 1/2 tubing set on a packer at approx. 4000'

D. Description of the proposed unloading, surface storage, and spill containment facilities:  
The unloading area will be concrete with a concrete vault to hold any spillage. The water will be stored in 210 or 400 BBL tanks which will be placed on a concrete pad with concrete walls. This dike will be of sufficient size to contain all water in case of tank failure.  
Trucks will unload through a strainer/ filter into the tanke. Water will be filtered to the injection pump.

RECEIVED

JUN 07 2012

33. **PROPOSED INJECTION VOLUMES**

A. Indicate the estimated amount of saltwater to be injected into the proposed injection well per day:  
AVERAGE: 800 MAXIMUM: 1600

B. Indicate the method to be used to measure the actual amount of saltwater injected into the well:  
Paperwork turned in by drivers. Electronics on unload station to monitor trucks & amount of water with flowmeter

34. **PROPOSED INJECTION PRESSURES**

A. Indicate the estimated pressure to be used for injection of saltwater into the proposed injection well:  
AVERAGE: 800 MAXIMUM: 1000 920 ps.

B. Indicate the method to be used to measure the actual daily injection pressure:  
Guages on wellhead recorded be well tender and electronics on the well with tranducers

35. **PROPOSED CORRECTIVE ACTION**

Explain any corrective action proposed for wells penetrating the proposed injection formation or zone within the area of review.  
The only well within the area of review is an existing disposal well

36. **MAP.** Each application for a permit shall be accompanied by a map or maps showing and containing the following information:
- A. The subject area trace or tracts of land and their owners upon which the proposed enhanced recovery operations are to be conducted;
  - B. The location and designation of all input, withdrawal, or observation wells on the tract or tracts to be utilized in the enhanced recovery project.
  - C. The geographic location of all wells, penetrating the formation proposed for injection regardless of status, within the area of review;
  - D. All holders of the land owner's royalty interest of record, or holders of the severed oil and gas mineral estates of record in the subject area.
  - E. All owners or operators of wells producing from or injecting into the same formation proposed as the injection formation.

37. **SCHEMATIC DRAWING OF SUBSURFACE CONSTRUCTION.** Label the schematic drawing below indicating size and setting depth of surface casing, intermediate (if any) and production casings; amount of cement used, measured or calculated tops of cement; size and setting depth of tubing; type and setting depth of packer; geologic name of injection zone showing top and bottom of injection interval. If the proposed input well design is substantially different from the schematic below, attach on a separate sheet a schematic of your proposal labeled with the above information.

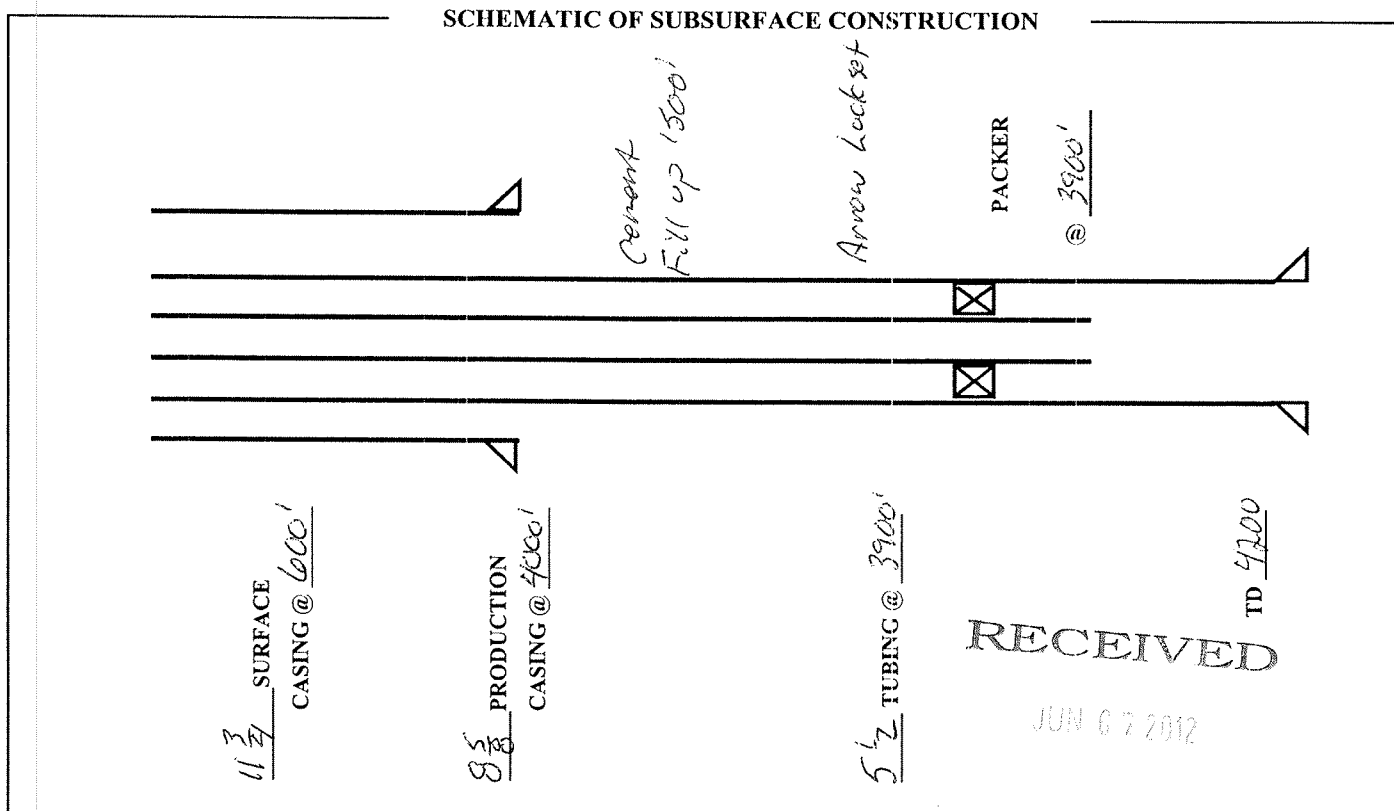

38. Public notice of an application for an enhanced recovery project is required by law. In addition, the applicant must submit, on an attached sheet, a list of the names and address of those persons required to receive personal notice in accordance with Rule 1501:9-5-05(E)(1), of the Ohio Administrative Code.

After submitting the application, and after a determination by the Division that it is complete as required by the rules of the Division, a legal notice must be published by the applicant in a newspaper of general circulation in the area of review. The legal notice must contain the information described in Rule 1501:9-5-05(E)(1) of the Ohio Administrative Code. A copy of the notice must be delivered to all owners or operators of wells within the area of review producing from or injecting into the same formation proposed as the injection formation. Proof of publication, publication date, and an oath as to the delivery to those entitled to receive personal notice under this method must be filed with the Division within thirty days after the Division determines that the application is complete.

In addition, notice of all applications for enhanced recovery projects will be published in the Division's Weekly Circular.

The undersigned hereby agrees to comply with all provisions for an enhanced recovery project as required by Chapter 1501:9-5 of the Ohio Administrative Code. In addition, the undersigned deposed and says that he shall conform to all provisions of Section 1509.072 of the Ohio Revised Code, and to all orders and rules issued by the Chief, Division of Oil and Gas Resources Management.

Owner/Authorized Agent (Type or Print): Charles J. Cutler  
 Signature of Owner/Authorized Agent: [Signature] Title: POES  
 Permanent Address of Home Office: 7646 Cedar Valley Rd W. Salem, OH 44267

If signed by Authorized Agent, a certified copy of appointment of agent must be on file with the Division.

SWORN to and subscribed before me this 4 day of June, 2012.



(SEAL) Kristin L. Anthony  
 Notary Public, State of Ohio  
 My Commission Expires  
 April 3, 2017

[Signature]  
 Notary Public  
April 4, 2012  
 Date Commission Expires



**SUPPLEMENT TO APPLICATION**  
**PERMIT FOR AN ENHANCED RECOVERY PROJECT (Form 203)**

Ohio Department of Natural Resources, Division of Oil and Gas Resources Management  
2045 Morse Road, Bldg H3  
Columbus, OH 43229-6693

AREA OF REVIEW. An application for an Enhanced Recovery Project (ERP) will be evaluated on the basis of an "area of review" surrounding the proposed input wells for the project. The area of review for projects in which injection of greater than two hundred barrels per day per well is proposed shall be the area circumscribed by a circle with one center point at the location of each input well and a radius of one-half mile. The area of review for projects in which a maximum injection of two hundred barrels per day per well or less is proposed shall be the area circumscribed by a circle with the center point at the location of each input well and a radius of one-quarter mile. Projects in which gas is the proposed injection fluid will have an area of review consisting of an area circumscribed by a circle with the center point at the location of each input well and a radius of one-quarter mile.

31. **PROPOSED INJECTION ZONE**

Geological Formation: \_\_\_\_\_ Newburg  
Injection Interval: From: 4050 <sup>4200 AA</sup> feet to 4200  
Geologic description of injection zone: \_\_\_\_\_

32. **WELL CONSTRUCTION AND OPERATION**

A. Description of the proposed casing and cement program for new wells, or of the casing, cementing or sealing with prepared clay for existing wells to be converted: <sup>AA</sup>  
11 3/4 casing surface to 600', 8 5/8 casing surface to TD approx 4200' cemented to surface, 5 1/2 tubing set on packer at approx. 4000'

B. Proposed method for testing the casing:  
Pressure test to be done after cementing of longstring and before perforation of longstring. Pressure up on longstring

C. Description of the proposed method for completion and operation of the injection well:  
5 1/2 tubing set on a packer at approx. 4000'

D. Description of the proposed unloading, surface storage, and spill containment facilities:  
The unloading area will be concrete with a concrete vault to hold any spillage. The water will be stored in 210 or 400 BBL tanks which will be placed on a concrete pad with concrete walls. This dike will be of sufficient size to contain all water in case of tank failure.  
Trucks will unload through a strainer/ filter into the tanks. Water will be filtered to the injection pump.

RECEIVED  
JUN 07 2012

33. **PROPOSED INJECTION VOLUMES**

A. Indicate the estimated amount of saltwater to be injected into the proposed injection well per day:  
AVERAGE: 800 MAXIMUM: 1600

B. Indicate the method to be used to measure the actual amount of saltwater injected into the well:  
Paperwork turned in by drivers. Electronics on unload station to monitor trucks & amount of water with flowmeter

34. **PROPOSED INJECTION PRESSURES**

A. Indicate the estimated pressure to be used for injection of saltwater into the proposed injection well:  
AVERAGE: 800 MAXIMUM: 1000 <sup>920 psi</sup> <sub>AA</sub>

B. Indicate the method to be used to measure the actual daily injection pressure:  
Guages on wellhead recorded by well tender and electronics on the well with transducers

35. **PROPOSED CORRECTIVE ACTION**

Explain any corrective action proposed for wells penetrating the proposed injection formation or zone within the area of review.  
The only well within the area of review is an existing disposal well

36. **MAP.** Each application for a permit shall be accompanied by a map or maps showing and containing the following information:
- A. The subject area trace or tracts of land and their owners upon which the proposed enhanced recovery operations are to be conducted;
  - B. The location and designation of all input, withdrawal, or observation wells on the tract or tracts to be utilized in the enhanced recovery project.
  - C. The geographic location of all wells, penetrating the formation proposed for injection regardless of status, within the area of review;
  - D. All holders of the land owner's royalty interest of record, or holders of the severed oil and gas mineral estates of record in the subject area.
  - E. All owners or operators of wells producing from or injecting into the same formation proposed as the injection formation.
37. **SCHEMATIC DRAWING OF SUBSURFACE CONSTRUCTION.** Label the schematic drawing below indicating size and setting depth of surface casing, intermediate (if any) and production casings; amount of cement used, measured or calculated tops of cement; size and setting depth of tubing; type and setting depth of packer; geologic name of injection zone showing top and bottom of injection interval. If the proposed input well design is substantially different from the schematic below, attach on a separate sheet a schematic of your proposal labeled with the above information.

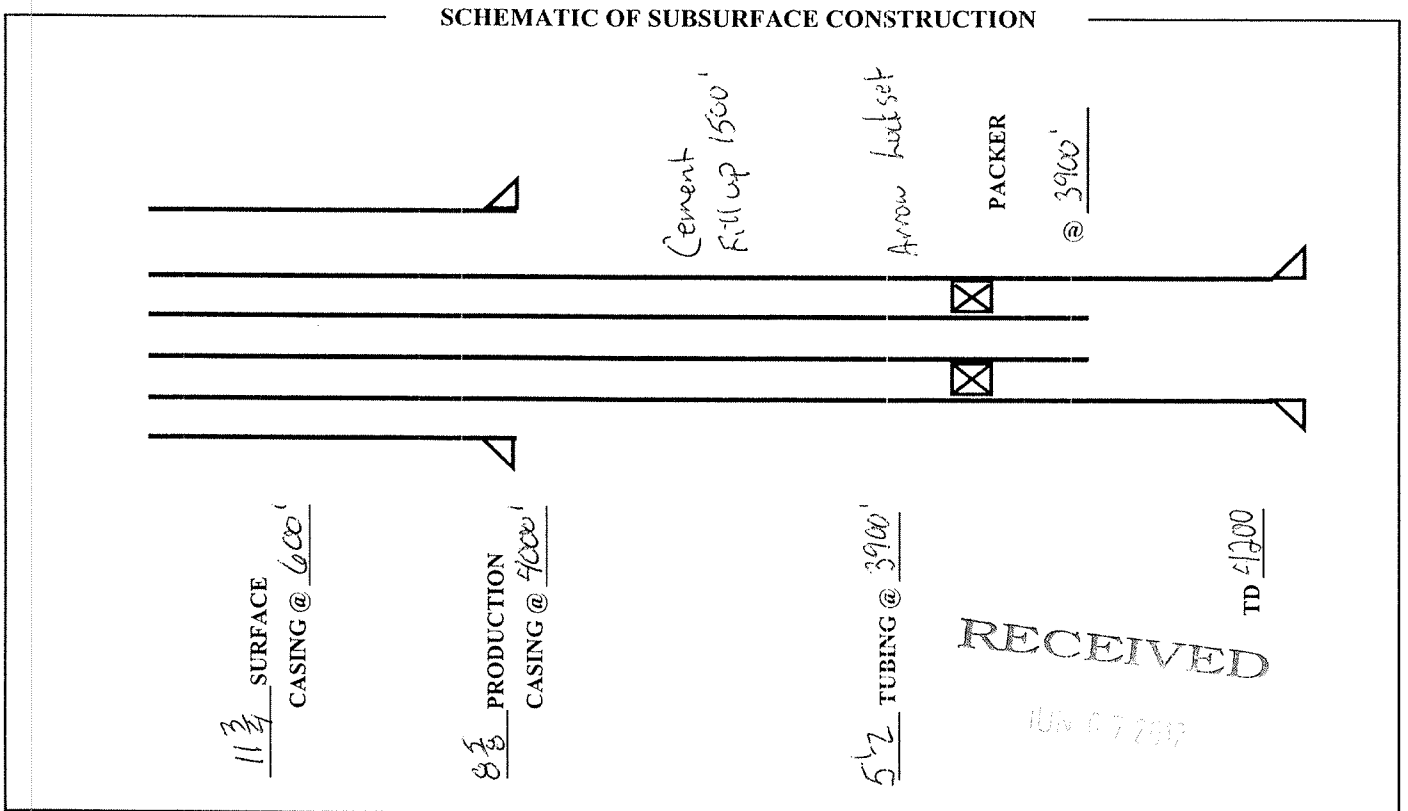

38. Public notice of an application for an enhanced recovery project is required by law. In addition, the applicant must submit, on an attached sheet, a list of the names and address of those persons required to receive personal notice in accordance with Rule 1501:9-5-05(E)(1), of the Ohio Administrative Code.

After submitting the application, and after a determination by the Division that it is complete as required by the rules of the Division, a legal notice must be published by the applicant in a newspaper of general circulation in the area of review. The legal notice must contain the information described in Rule 1501:9-5-05(E)(1) of the Ohio Administrative Code. A copy of the notice must be delivered to all owners or operators of wells within the area of review producing from or injecting into the same formation proposed as the injection formation. Proof of publication, publication date, and an oath as to the delivery to those entitled to receive personal notice under this method must be filed with the Division within thirty days after the Division determines that the application is complete.

In addition, notice of all applications for enhanced recovery projects will be published in the Division's Weekly Circular.

The undersigned hereby agrees to comply with all provisions for an enhanced recovery project as required by Chapter 1501:9-5 of the Ohio Administrative Code. In addition, the undersigned deposed and says that he shall conform to all provisions of Section 1509.072 of the Ohio Revised Code, and to all orders and rules issued by the Chief, Division of Oil and Gas Resources Management.

Owner/Authorized Agent (Type or Print): Charles J Coffey  
 Signature of Owner/Authorized Agent: [Signature] Title: Pres  
 Permanent Address of Home Office: 7646 Cedar Valley Rd W. Salem, OH 44287

If signed by Authorized Agent, a certified copy of appointment of agent must be on file with the Division.

SWORN to and subscribed before me this 4 day of June, 2012.



Kristin L. Anthony  
 (SEAL)  
 Notary Public, State of Ohio  
 My Commission Expires  
 April 3, 2017

[Signature]  
 Notary Public  
April 3, 2017  
 Date Commission Expires

**Subsurface Construction  
For Injection Well**

**Maximum Injection Pressure: 920 psi**

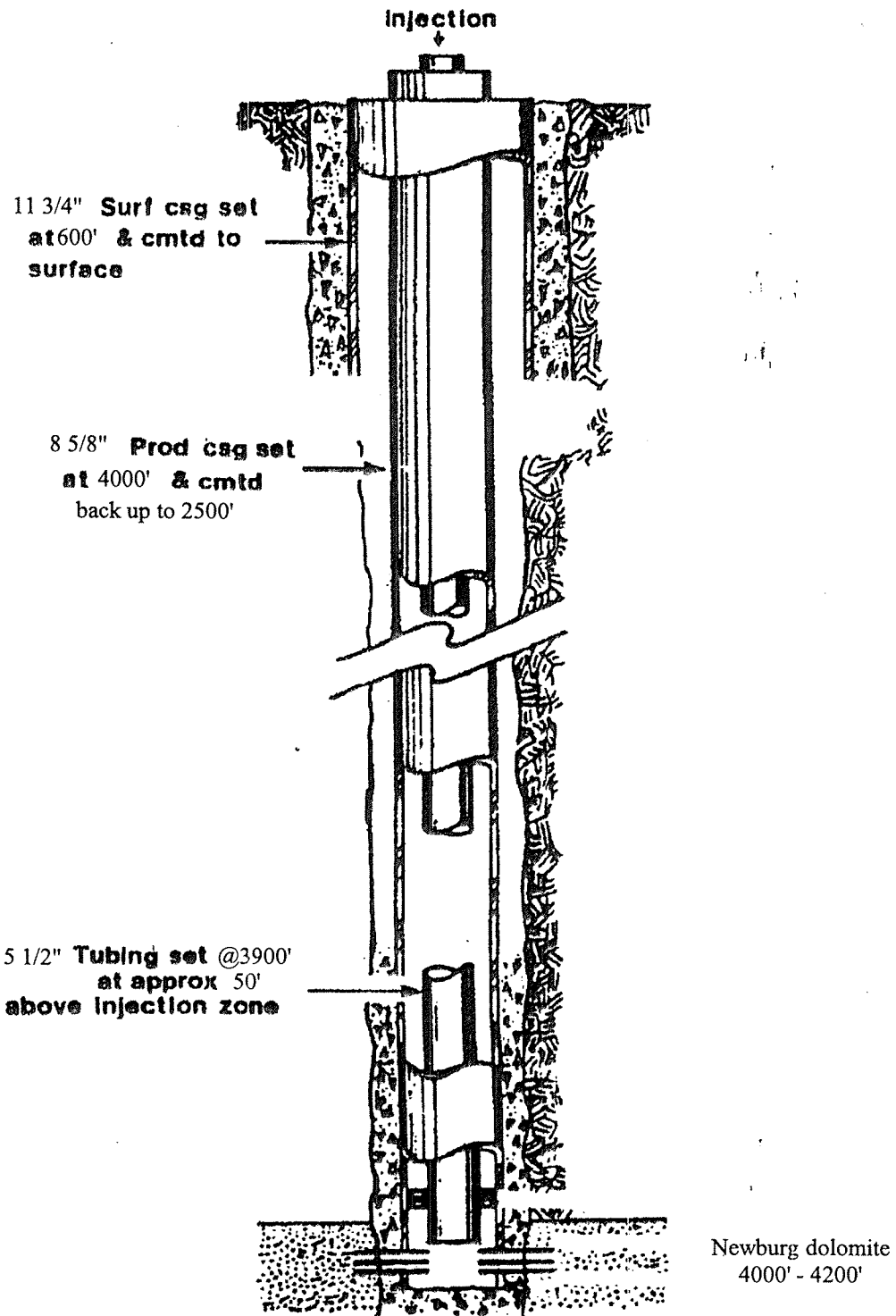

**Total Depth: 4200'**

Portage County, Windham Twp., SWIW # 41  
Soinski SWD # 5

**Subsurface Construction  
For Injection Well**

Maximum Injection Pressure: 920 psi

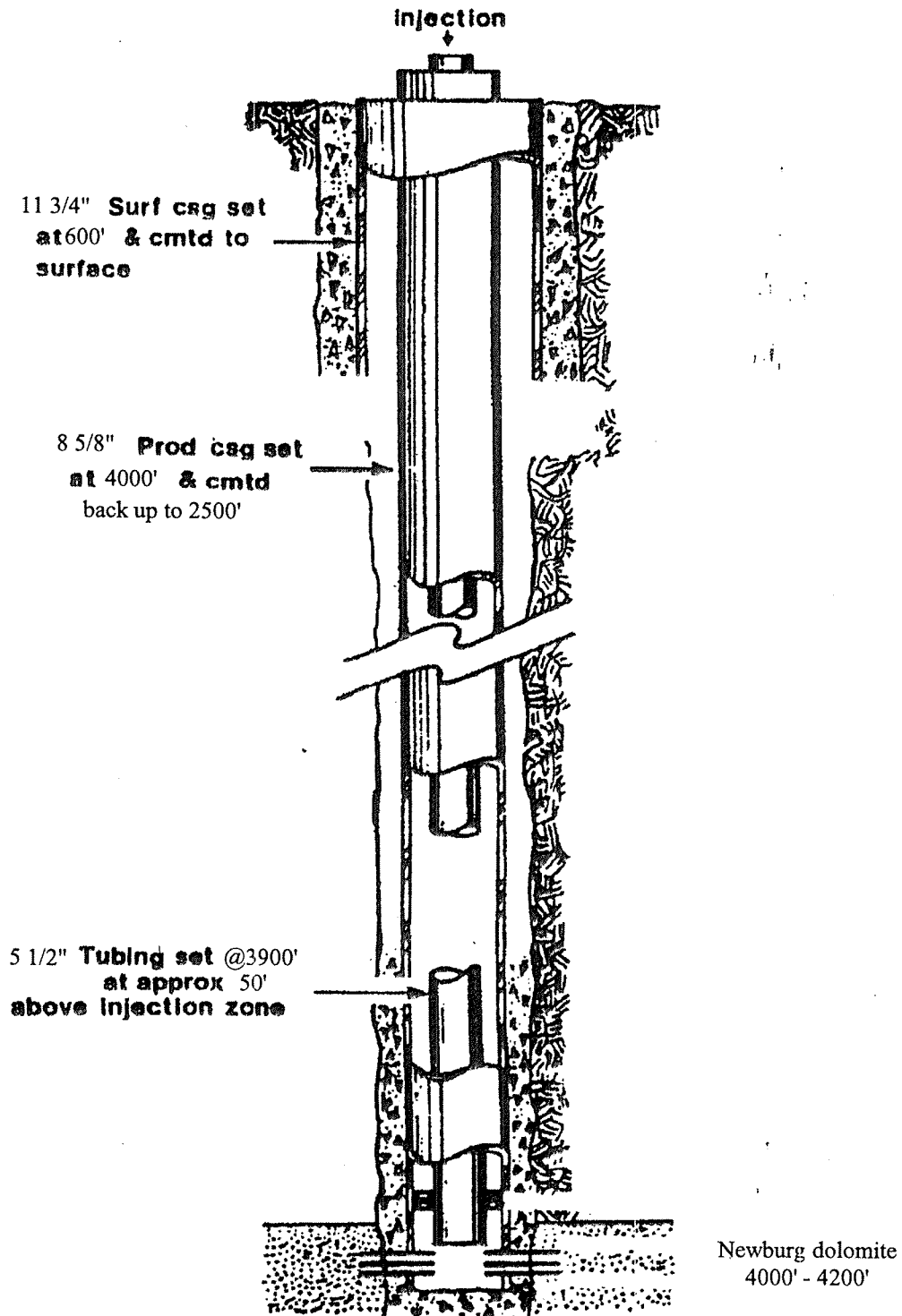

**Total Depth: 4200'**

PARTIAL RELEASE OF OIL AND GAS LEASE RIGHTS

The undersigned, America's Energy Exploration, Inc. and Perry Petroleum, LLC, (collectively "Lessees") for valuable consideration the receipt of which is hereby acknowledged, do hereby release and relinquish the right to produce oil and gas from geologic formations located from the surface to the top of the Queenston Formation, in and to the following:

Oil and Gas Lease, recorded with the Recorder of Portage County, Ohio, in Official Record Instrument Number 201011014.

This Partial Release shall not affect the rights of Lessees and their successors and assigns to drill through the above described geologic formations to explore for and produce oil and gas from deeper geologic formations.

Signed on September 8, 2011.

America's Energy Exploration, Inc.

By: [Signature]

Its: [Signature]

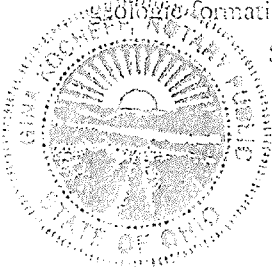

STATE OF OHIO,  
COUNTY OF Portage, SS:

The foregoing instrument was acknowledged before me this   th day of September 2011 by Cynthia L. Covert, President of America's Energy Exploration, Inc., an Ohio corporation, on behalf of the corporation.

[Signature]  
Notary Public, State of Ohio  
My Commission Expires 2-28-2014

Notary Public

Signed on September   , 2011.

Perry Petroleum, LLC

By: [Signature]

Its: [Signature]

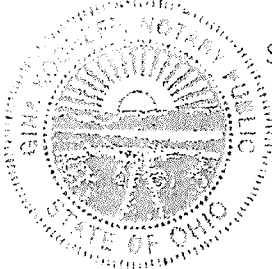

STATE OF OHIO,  
COUNTY OF Portage, SS:

The foregoing instrument was acknowledged before me this   th day of September 2011 by Perry Pipes, manager of Perry Petroleum, LLC, an Ohio limited liability company, on behalf of the company.

[Signature]  
Notary Public, State of Ohio  
My Commission Expires 2-28-2014

Notary Public

This Instrument Prepared By:

PARTIAL RELEASE OF OIL AND GAS LEASE RIGHTS

The undersigned, America's Energy Exploration, Inc. and Perry Petroleum, LLC, (collectively "Lessees") for valuable consideration the receipt of which is hereby acknowledged, do hereby release and relinquish the right to produce oil and gas from geologic formations located from the surface to the top of the Queenston Formation, in and to the following:

Oil and Gas Lease, recorded with the Recorder of Trumbull County, Ohio, in Official Record Instrument Number 201007160012822.

This Partial Release shall not affect the rights of Lessees and their successors and assigns to drill through the above described geologic formations to explore for and produce oil and gas from deeper geologic formations.

Signed on September 1, 2011.



America's Energy Exploration, Inc.

By: [Signature]

Its: [Signature]

STATE OF OHIO,  
COUNTY OF Warren, SS:

The foregoing instrument was acknowledged before me this 1th day of September 2011 by Cynthia L. Covert, President of America's Energy Exploration, Inc., an Ohio corporation, on behalf of the corporation.

[Signature]  
Notary Public, State of Ohio  
My Commission Expires 3-26-2014

[Signature]  
Notary Public

Signed on September 1, 2011.

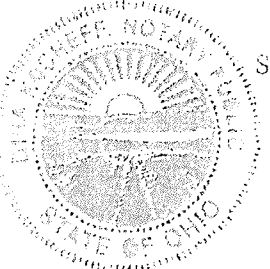

Perry Petroleum, LLC

By: [Signature]

Its: [Signature]

STATE OF OHIO,  
COUNTY OF Warren, SS:

The foregoing instrument was acknowledged before me this 1th day of September 2011 by Perry Pipes, manager of Perry Petroleum, LLC, an Ohio limited liability company, on behalf of the company.

[Signature]  
Notary Public, State of Ohio  
My Commission Expires 3-26-2014

[Signature]  
Notary Public

This Instrument Prepared By:  
Christopher C. Wager  
Vorys, Sater, Seymour and Pease LLP  
52 East Gay Street  
P.O. Box 1008, Columbus, OH 43216-1008

Hard Rock Drilling & Producing  
7646 Cedar Valley Road  
West Salem, Ohio 44287

June 21, 2012

Division of Mineral Resources Management

2045 Morse Road, Bldg. H-3

Columbus, Ohio 43229

Dear Tom,

As per your request on the mineral rights under the Solinski property I am sending you the partial release on the mineral rights under the Solinski property. The permit from Pep drilling was submitted before the release of the mineral rights back to Dale Solinski. As to our research on the property we have leased the minerals from the surface to the top of the Queenston. If you have any other questions please feel free to contact me.

Thanks,

CJ Cutter

**RESTORATION PLAN (Form 4)**

Ohio Department of Natural Resources

Division of Oil and Gas Resources Management, 2045 Morse Road, Bldg. H-3, Columbus OH 43229-6693

1. DATE OF APPLICATION: <u>Jun-12</u>	
2. OWNER NAME, ADDRESS, & TELEPHONE NO.: Hard Rock Drilling & Producing LLC, 7646 Cedar Valley Road, West Salem, Ohio 44287 (419) 846-3850	3. API #:
	4. WELL #: <u>5l</u>
	5. LEASE NAME: <u>Soinski</u>
	6. PROPERTY OWNER: <u>Dale Soinski</u>
	7. COUNTY: <u>Portage</u>
	8. CIVIL TOWNSHIP: <u>Nelson</u>
	9. SECTION: <u>10.</u> LOT: <u>45</u>
11. CURRENT LAND USE: <input type="checkbox"/> Cropland <input type="checkbox"/> Commercial <input type="checkbox"/> Pasture <input type="checkbox"/> Idle Land <input type="checkbox"/> Wetlands <input checked="" type="checkbox"/> Recreational <input type="checkbox"/> Residential <input type="checkbox"/> Industrial <input type="checkbox"/> Unreclaimed strip mine <input type="checkbox"/> Woodland: <input type="checkbox"/> Broadleaf <input type="checkbox"/> Needlelike	17. TYPE OF WELL: <input type="checkbox"/> Oil <input type="checkbox"/> Gas <input checked="" type="checkbox"/> Other
12. SLOPE GRADIENT & LENGTH DETERMINED FROM: <input checked="" type="checkbox"/> Ground Measurement <input type="checkbox"/> U.S. Geological Survey Topographical Maps <input type="checkbox"/> Other: (explain) _____	18. STEEPEST SLOPE GRADIENT CROSSING SITE: <input checked="" type="checkbox"/> 0 to 2% <input type="checkbox"/> 2.1 to 8% <input type="checkbox"/> 8.1 to 10% <input type="checkbox"/> 10.1 to 24% <input type="checkbox"/> greater than 24%
13. TYPE OF FALL VEGETAL COVER: <input checked="" type="checkbox"/> Little or no vegetal cover <input type="checkbox"/> Short grasses <input type="checkbox"/> Tall weeds or short brush (1 to 2 ft.) <input type="checkbox"/> Brush or bushes (2 to 6 ft.) <input type="checkbox"/> Agricultural crops <input type="checkbox"/> Trees with sparse low brush <input type="checkbox"/> Trees with dense low brush	19. LENGTH OF STEEPEST SLOPE CROSSING SITE: <input checked="" type="checkbox"/> 1 to 100 ft. <input type="checkbox"/> 101 to 200 ft. <input type="checkbox"/> 201 to 400 ft. <input type="checkbox"/> greater than 400 ft.
14. SOIL & RESOILING MATERIAL AT WELLSITE: <input checked="" type="checkbox"/> Stockpile and protect topsoil to be used when preparing seedbed <input type="checkbox"/> Use of soil additives (e.g., lime, fertilizer) <input type="checkbox"/> No resoiling planned <input type="checkbox"/> Proposed alternative _____	20. RESTORATION OF DRILLING PITS: ** <input checked="" type="checkbox"/> Haul drilling fluids and fill pits <input type="checkbox"/> Use steel circulating tanks <input type="checkbox"/> Proposed alternative _____
15. DISPOSAL PLAN FOR TREES AND TREE STUMPS: <input type="checkbox"/> No trees disturbed <input type="checkbox"/> Haul to landfill <input checked="" type="checkbox"/> Cut into firewood <input type="checkbox"/> Sell to lumber company <input type="checkbox"/> Bury with landowner's approval <input checked="" type="checkbox"/> Mulch small trees and branches, erosion control <input type="checkbox"/> Use for wildlife habitat with landowner approval <input type="checkbox"/> Proposed alternative _____	21. BACKFILLING AND GRADING AT SITE: <input type="checkbox"/> Construct diversions channeled to naturally established drainage systems <input type="checkbox"/> Construct terraces across slopes <input checked="" type="checkbox"/> Grade to approximate original contour <input type="checkbox"/> Grade to minimize erosion & control offsite runoff <input type="checkbox"/> Proposed alternative _____
16. SURFACE AND SUBSURFACE DRAINAGE FACILITIES: <input checked="" type="checkbox"/> No existing drainage facilities for removal of surface and/or subsurface water <input type="checkbox"/> Tile drainage system underlying land to be disturbed <input type="checkbox"/> Drain pipe(s) underlying land to be disturbed <input type="checkbox"/> Surface drainage facilities on land to be disturbed	22. VEGETATIVE COVER TO BE ESTABLISHED AT SITE: <input checked="" type="checkbox"/> Seeding plan <input type="checkbox"/> Sod <input type="checkbox"/> Agricultural crops <input type="checkbox"/> Trees and/or Bushes <input type="checkbox"/> Proposed alternative _____
	23. ADDITIONAL HOLES: <input checked="" type="checkbox"/> Rat/Mouse, if used, will be plugged
	24. PROPOSED OR CURRENT LENGTH OF ACCESS ROAD: <input type="checkbox"/> 100 ft. or less <input type="checkbox"/> 101 to 500 ft. <input type="checkbox"/> 501 to 1500 ft. <input checked="" type="checkbox"/> greater than 1500 ft.
	25. CURRENT LAND USE OF PATH OF ACCESS ROAD: <input type="checkbox"/> Cropland <input type="checkbox"/> Pasture <input type="checkbox"/> Commercial <input type="checkbox"/> Idle land <input type="checkbox"/> Wetlands <input checked="" type="checkbox"/> Recreational <input type="checkbox"/> Industrial <input type="checkbox"/> Residential <input type="checkbox"/> Unreclaimed strip mine <input type="checkbox"/> Woodland: <input type="checkbox"/> Broadleaf <input type="checkbox"/> Needlelike

**\*\*PITS MUST BE FILLED WITHIN TWO MONTHS AFTER COMMENCEMENT OF THE WELL AND WITHIN FOURTEEN DAYS AFTER COMMENCEMENT OF THE WELL IN AN URBANIZED AREA.**

**REQUIRED BY SECTION 1509.06 (A)(10), OHIO REVISED CODE -- FAILED TO SUBMIT MAY RESULT IN AN ASSESSMENT OF CRIMINAL FINES NOT LESS THAN \$100.00 NOR MORE THAN \$2,000.00 OR CIVIL PENALTIES NOT LESS THAN \$4,000.00.**



26. SURFACING MATERIAL FOR ACCESS ROAD: <input type="checkbox"/> Gravel <input type="checkbox"/> Brick and/or tile waste <input type="checkbox"/> Slag <input checked="" type="checkbox"/> Crushed stone <input type="checkbox"/> No surfacing material to be used <input type="checkbox"/> Proposed alternative _____	29. STEEPEST SLOPE GRADIENT ON ACCESS ROAD: <input checked="" type="checkbox"/> 0 to 5% <input type="checkbox"/> 6 to 10% <input type="checkbox"/> greater than 10%
27. PATH OF ACCESS ROAD TO BE DETERMINED BY: <input type="checkbox"/> Landowner <input type="checkbox"/> Contractor <input type="checkbox"/> Existing access road <input checked="" type="checkbox"/> Operator	30. APPROXIMATE LENGTH OF STEEPEST SLOPE ON ROAD: <input checked="" type="checkbox"/> 0 to 100 ft. <input type="checkbox"/> 101 to 200 ft. <input type="checkbox"/> 201 to 400 ft. <input type="checkbox"/> greater than 400 ft.
28. GRADING AND EROSION CONTROL PRACTICE ON ROAD: <input type="checkbox"/> Diversions <input type="checkbox"/> Filter strips <input type="checkbox"/> Drains <input type="checkbox"/> Riprap <input type="checkbox"/> Open top culverts <input type="checkbox"/> Water breaks <input checked="" type="checkbox"/> Outsloping of road <input type="checkbox"/> Pipe culverts <input type="checkbox"/> Proposed alternative _____	31. HAS LANDOWNER RECEIVED A COPY OF THIS RESTORATION PLAN? <input type="checkbox"/> Yes <input checked="" type="checkbox"/> No

The undersigned hereby agrees to implement all restoration operations identified on this form, and conform to all provisions of Section 1509.072 of the Ohio Revised Code, and to all Orders and rules issued by the Chief, Division of Oil and Gas Resources Management.

Signature of Owner/Authorized Agent 

Name (Typed or Printed) Charles J Cutler Date 6-4-12

RESTORATION PLAN MUST BE SUBMITTED TO THE DIVISION IN DUPLICATE.

RECEIVED

Jun 07 2012

**RESTORATION PLAN (Form 4)**

Ohio Department of Natural Resources

Division of Oil and Gas Resources Management, 2045 Morse Road, Bldg. H-3, Columbus OH 43229-6693

1. DATE OF APPLICATION: Jun-12	
2. OWNER NAME, ADDRESS, & TELEPHONE NO.: Hard Rock Drilling & Producing LLC, 7646 Cedar Valley Road, West Salem, Ohio 44287 (419) 846-3850	3. API #:
	4. WELL #: 5I
	5. LEASE NAME: Soinski
	6. PROPERTY OWNER: Dale Soinski
	7. COUNTY: Portage
	8. CIVIL TOWNSHIP: Nelson
	9. SECTION: 10. LOT: 45
11. CURRENT LAND USE: <input type="checkbox"/> Cropland <input type="checkbox"/> Commercial <input type="checkbox"/> Pasture <input type="checkbox"/> Idle Land <input type="checkbox"/> Wetlands <input checked="" type="checkbox"/> Recreational <input type="checkbox"/> Residential <input type="checkbox"/> Industrial <input type="checkbox"/> Unreclaimed strip mine <input type="checkbox"/> Woodland: <input type="checkbox"/> Broadleaf <input type="checkbox"/> Needlelike	17. TYPE OF WELL: <input type="checkbox"/> Oil <input type="checkbox"/> Gas <input checked="" type="checkbox"/> Other
12. SLOPE GRADIENT & LENGTH DETERMINED FROM: <input checked="" type="checkbox"/> Ground Measurement <input type="checkbox"/> U.S. Geological Survey Topographical Maps <input type="checkbox"/> Other: (explain) _____	18. STEEPEST SLOPE GRADIENT CROSSING SITE: <input checked="" type="checkbox"/> 0 to 2% <input type="checkbox"/> 2.1 to 8% <input type="checkbox"/> 8.1 to 10% <input type="checkbox"/> 10.1 to 24% <input type="checkbox"/> greater than 24%
13. TYPE OF FALL VEGETAL COVER: <input checked="" type="checkbox"/> Little or no vegetal cover <input type="checkbox"/> Short grasses <input type="checkbox"/> Tall weeds or short brush (1 to 2 ft.) <input type="checkbox"/> Brush or bushes (2 to 6 ft.) <input type="checkbox"/> Agricultural crops <input type="checkbox"/> Trees with sparse low brush <input type="checkbox"/> Trees with dense low brush	19. LENGTH OF STEEPEST SLOPE CROSSING SITE: <input checked="" type="checkbox"/> 1 to 100 ft. <input type="checkbox"/> 101 to 200 ft. <input type="checkbox"/> 201 to 400 ft. <input type="checkbox"/> greater than 400 ft.
14. SOIL & RESOILING MATERIAL AT WELLSITE: <input checked="" type="checkbox"/> Stockpile and protect topsoil to be used when preparing seedbed <input type="checkbox"/> Use of soil additives (e.g., lime, fertilizer) <input type="checkbox"/> No resoiling planned <input type="checkbox"/> Proposed alternative _____	20. RESTORATION OF DRILLING PITS: ** <input checked="" type="checkbox"/> Haul drilling fluids and fill pits <input type="checkbox"/> Use steel circulating tanks <input type="checkbox"/> Proposed alternative _____
15. DISPOSAL PLAN FOR TREES AND TREE STUMPS: <input type="checkbox"/> No trees disturbed <input type="checkbox"/> Haul to landfill <input checked="" type="checkbox"/> Cut into firewood <input type="checkbox"/> Sell to lumber <input type="checkbox"/> Bury with landowner's approval      company <input checked="" type="checkbox"/> Mulch small trees and branches, erosion control <input type="checkbox"/> Use for wildlife habitat with landowner approval <input type="checkbox"/> Proposed alternative _____	21. BACKFILLING AND GRADING AT SITE: <input type="checkbox"/> Construct diversions channeled to naturally established drainage systems <input type="checkbox"/> Construct terraces across slopes <input checked="" type="checkbox"/> Grade to approximate original contour <input type="checkbox"/> Grade to minimize erosion & control offsite runoff <input type="checkbox"/> Proposed alternative _____
	22. VEGETATIVE COVER TO BE ESTABLISHED AT SITE: <input checked="" type="checkbox"/> Seeding plan <input type="checkbox"/> Sod <input type="checkbox"/> Agricultural crops <input type="checkbox"/> Trees and/or Bushes <input type="checkbox"/> Proposed alternative _____
	23. ADDITIONAL HOLES: <input checked="" type="checkbox"/> Rat/Mouse, if used, will be plugged
	24. PROPOSED OR CURRENT LENGTH OF ACCESS ROAD: <input type="checkbox"/> 100 ft. or less <input type="checkbox"/> 101 to 500 ft. <input type="checkbox"/> 501 to 1500 ft. <input checked="" type="checkbox"/> greater than 1500 ft.
16. SURFACE AND SUBSURFACE DRAINAGE FACILITIES: <input checked="" type="checkbox"/> No existing drainage facilities for removal of surface and/or subsurface water <input type="checkbox"/> Tile drainage system underlying land to be disturbed <input type="checkbox"/> Drain pipe(s) underlying land to be disturbed <input type="checkbox"/> Surface drainage facilities on land to be disturbed	25. CURRENT LAND USE OF PATH OF ACCESS ROAD: <input type="checkbox"/> Cropland <input type="checkbox"/> Pasture <input type="checkbox"/> Commercial <input type="checkbox"/> Idle land <input type="checkbox"/> Wetlands <input checked="" type="checkbox"/> Recreational <input type="checkbox"/> Industrial <input type="checkbox"/> Residential <input type="checkbox"/> Unreclaimed strip mine <input type="checkbox"/> Woodland: <input type="checkbox"/> Broadleaf <input type="checkbox"/> Needlelike

**\*\*PITS MUST BE FILLED WITHIN TWO MONTHS AFTER COMMENCEMENT OF THE WELL AND WITHIN FOURTEEN DAYS AFTER COMMENCEMENT OF THE WELL IN AN URBANIZED AREA.**

**REQUIRED BY SECTION 1509.06 (A)(10), OHIO REVISED CODE -- FAILED TO SUBMIT MAY RESULT IN AN ASSESSMENT OF CRIMINAL FINES NOT LESS THAN \$100.00 NOR MORE THAN \$2,000.00 OR CIVIL PENALTIES NOT LESS THAN \$4,000.00.**

26. SURFACING MATERIAL FOR ACCESS ROAD: <input type="checkbox"/> Gravel <input type="checkbox"/> Brick and/or tile waste <input type="checkbox"/> Slag <input checked="" type="checkbox"/> Crushed stone <input type="checkbox"/> No surfacing material to be used <input type="checkbox"/> Proposed alternative _____	29. STEEPEST SLOPE GRADIENT ON ACCESS ROAD: <input checked="" type="checkbox"/> 0 to 5% <input type="checkbox"/> 6 to 10% <input type="checkbox"/> greater than 10%
27. PATH OF ACCESS ROAD TO BE DETERMINED BY: <input type="checkbox"/> Landowner <input type="checkbox"/> Contractor <input type="checkbox"/> Existing access road <input checked="" type="checkbox"/> Operator	30. APPROXIMATE LENGTH OF STEEPEST SLOPE ON ROAD: <input checked="" type="checkbox"/> 0 to 100 ft. <input type="checkbox"/> 101 to 200 ft. <input type="checkbox"/> 201 to 400 ft. <input type="checkbox"/> greater than 400 ft.
28. GRADING AND EROSION CONTROL PRACTICE ON ROAD: <input type="checkbox"/> Diversions <input type="checkbox"/> Filter strips <input type="checkbox"/> Drains <input type="checkbox"/> Riprap <input type="checkbox"/> Open top culverts <input type="checkbox"/> Water breaks <input checked="" type="checkbox"/> Outsloping of road <input type="checkbox"/> Pipe culverts <input type="checkbox"/> Proposed alternative _____	31. HAS LANDOWNER RECEIVED A COPY OF THIS RESTORATION PLAN? <input type="checkbox"/> Yes <input checked="" type="checkbox"/> No

The undersigned hereby agrees to implement all restoration operations identified on this form, and conform to all provisions of Section 1509.072 of the Ohio Revised Code, and to all Orders and rules issued by the Chief, Division of Oil and Gas Resources Management.

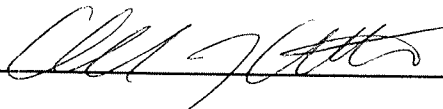
Signature of Owner/Authorized Agent   
Name (Typed or Printed) Charles J Utter Date 6-4-12

RESTORATION PLAN MUST BE SUBMITTED TO THE DIVISION IN DUPLICATE.

RECEIVED

JUN 07 2012